

BILL NO. 1 NOTES

MEANING OF TERM "TENDER / TENDERER"

Any reference to words "Tender" or "Tenderer" herein and/or in any other documentation shall be construed to have the same meaning as the words "Bid" or "Bidder".

PRELIMINARIES

The JBCC Preliminaries Code 2103, May 2005 edition for use with the JBCC Principal Building Agreement Edition 4.1 Code 2101, March 2005 is taken to be incorporated herein. The tenderer is deemed to have referred to these documents for the full intent and meaning of each clause. These clauses are referred to by number and heading only. Where standard clauses or options are not applicable to the contract such modifications or corrections as are necessary are given under each relevant clause. Where an item is not relevant to this specific contract such item is marked "N/A" signifying "Not Applicable"

Contractors are referred to the above mentioned documents for the full intent and meaning of each clause thereof

These clauses are hereinafter referred to by clause number and heading only. Where standard clauses or alternatives are not entirely applicable to this contract such modifications, corrections or supplements as will apply are given under each relevant clause heading and such modifications, corrections or supplements shall take precedence notwithstanding anything contrary contained in the above mentioned documents

Carried to Collection

Section No. 1
Bill No. 1
PRELIMINARIES

DEVELOPMENT BANK OF SOUTH AFRICA

Quantity

Rate

Amount

R

Where any item is not relevant to this specific contract such item is marked N/A, signifying "not applicable"

PRICING OF PRELIMINARIES

Should Option A, as set out in clause B10.3.1 hereinafter be used for the adjustment of preliminaries then each item priced is to be allocated to one or more of the three categories Fixed, Value Related or Time Related and the respective amounts entered in the spaces provided under each item

Items not priced in these Preliminaries shall be deemed to be included elsewhere in these Bills of Quantities

SECTION A - PRINCIPAL BUILDING AGREEMENT

Definitions

1 Clause 1.0 - Definitions and interpretation
F:..... V:.....
T:.....

Item

Clause 1.1 Definition of "**Commencement Date**" is added:

"**COMMENCEMENT DATE**" means the date that the **agreement**, made in terms of the Form of Offer and Acceptance, comes into effect

Clause 1.1 Definition of "**Construction Guarantee**" is amended by replacing it with the following:

"**CONSTRUCTION GUARANTEE**" means a guarantee at call obtained by the **contractor** from an institution approved by the **employer** in terms of the **employer's** construction guarantee form as selected in the **schedule**

Clause 1.1 Definition of "**Construction Period**" is amended by replacing it with the following:

"**CONSTRUCTION PERIOD**" means the period commencing on the **commencement date** and ending on the date of **practical completion**

Carried to Collection

R

Section No. 1
Bill No. 1
PRELIMINARIES

DEVELOPMENT BANK OF SOUTH AFRICA

Clause 1.1 Definition of "**Corrupt Practice**" is added:

"**CORRUPT PRACTICE**" means the offering, giving, receiving or soliciting of anything of value to influence the action of a public official in the procurement process or in contract execution

Clause 1.1 Definition of "**Fraudulent Practice**" is added:

"**FRAUDULENT PRACTICE**" means a misrepresentation of facts in order to influence a procurement process or the execution of a contract to the detriment of any tenderer and includes collusive practice among tenderers (prior to or after the tender submission) designed to establish tender prices at artificial non-competitive levels and to deprive the tenderer of the benefits of free and open competition

Clause 1.1 Definition of "**Interest**" is amended by replacing it with the following:

"**INTEREST**" means the interest rates applicable on this contract, whether specifically indicated in the relevant clauses or not, will be the rate as determined by the Minister of Finance, from time to time, in terms of section 80(1)(b) of the Public Finance Management Act, 1999 (Act No. 1 of 1999)

Clause 1.1 Definition of "**Principal Agent**" is amended by replacing it with the following:

"**PRINCIPAL AGENT**" means the person or entity appointed by the **employer** and named in the **schedule**. In the event of a **principal agent** not being appointed, then all the duties and obligations of a **principal agent** as detailed in the **agreement** shall be fulfilled by a representative of the **employer** as named in the **schedule**

Clause 1.1 Definition of "**Security**" is amended by replacing it with the following:

"**SECURITY**" means the form of security provided by the **employer** or **contractor**, as stated in the **schedule**, from which the **contractor** or **employer** may recover expense or loss

Carried to Collection

Section No. 1
Bill No. 1
PRELIMINARIES

DEVELOPMENT BANK OF SOUTH AFRICA

R

Clause 1.6 is amended by replacing the words "prepaid registered post, telefax or e-mail" with "prepaid registered post or telefax"

Clause 1.6.4 is amended by replacing it with the following:
No Clause

Objective and preparations

2 Clause 2.0 - Offer acceptance and performance obligations F:..... V:.....
T:.....

Item

3 Clause 3.0 - Documents F:.....
V:..... T:.....

Item

Clause 3.2.1 is amended by replacing "14.1" with "14.0"

Clause 3.7 is amended by the addition of the following:

The **contractor** shall supply and keep a copy of the **JBCC** Series 2000 Principal Building Agreement and Preliminaries applicable to this contract on the **site**, to which the **employer, principal agent** and **agents** shall have access at all times

Clause 3.10 is amended by replacing the second reference to "**principal agent**" with the word "**employer**"

4 Clause 4.0 - Design responsibility F:.....
V:..... T:.....

Item

5 Clause 5.0 - Employer's agents F:.....
V:..... T:.....

Item

Clause 5.1.2 is amended to include clauses 32.6.3, 34.3, 34.4 and 38.5.8

6 Clause 6.0 - Contractor's site representative
F:..... V:..... T:

Item

Carried to Collection

R

Section No. 1
Bill No. 1
PRELIMINARIES

DEVELOPMENT BANK OF SOUTH AFRICA

7	<p>Clause 7.0 - Compliance with laws and regulations</p> <p>F: R..... V:..... T: R</p> <p>Without limiting the generality of the provisions of clause 7.0, the contractor's attention is drawn to the provisions of the Construction Regulations, 2003 issued in terms of the Occupational Health and Safety Act, 1993. It is specifically stated that the employer shall prepare a documented health and safety specification for the works and that the employer shall ensure that the contractor has made provision for the cost of health and safety measures during the execution of the works. The contractor shall price opposite this item for compliance with the act and the regulations and the reasonable provisions of the aforementioned health and safety specifications</p> <p>Note: A separate clause has been included in Section C : Specific Preliminaries of the bills of quantities / lump sum document for the contractor to have the opportunity to price for all the requirements of the Occupational Health and Safety Act, Construction Regulations and Health and Safety Specification</p>	Item		
8	<p>Clause 8.0 - Works risk</p> <p>F: V:..... T:.....</p>	Item		
9	<p>Clause 9.0 - Indemnities</p> <p>F:V:..... T:.....</p>	Item		
10	<p>Clause 10.0 - General insurances F:..... V:.....T:.....</p>	Item		
Carried to Collection			R	
<p>Section No. 1 Bill No. 1 PRELIMINARIES</p> <p style="text-align: right;">DEVELOPMENT BANK OF SOUTH AFRICA</p>				

- 11 Clause 10.0 is amended by the addition of the following clauses:
- 10.5 Damage to the Works
- a. Without in any way limiting the **contractor's** obligations in terms of the contract, the **contractor** shall bear the full risk of damage to and/or destruction of the **works** by whatever cause during construction of the **works** and hereby indemnifies and holds harmless the **employer** against any such damage. The **contractor** shall take such precautions and security measures and other steps for the protection and security of the **works** as the **contractor** may deem necessary
- b. The **contractor** shall at all times proceed immediately to remove or dispose of any debris arising from damage to or destruction of the **works** and to rebuild, restore, replace and/or repair the **works**
- c. The **employer** shall carry the risk of damage to or destruction of the **works** and materials paid for by the **employer** that is the result of the excepted risks as set out in 10.6
- d. Where the **employer** bears the risk in terms of this contract, the **contractor** shall, if requested to do so, reinstate any damage or destroyed portions of the **works** and the costs of such reinstatement shall be measured and valued in terms of 32.0 hereof

m

- 12 **10.6 Injury to Persons or loss of or damage to Properties**
- a. The **contractor** shall be liable for and hereby indemnifies the **employer** against any liability, loss, claim or proceeding whether arising in common law or by statute, consequent upon personal injuries to or the death of any person whomsoever arising out of or in the course of or caused by the execution of the **works** unless due to any act or negligence of any person for whose actions the **employer** is legally liable
- b. The **contractor** shall be liable for and hereby indemnifies the **employer** against any liability, loss, claim or proceeding consequent upon loss of or damage to any moveable or immovable or personal property or property contiguous to the **site**, whether belonging to or under the control of the **employer** or any other body or person, arising out of or in the course of or by reason of

Carried to Collection

R

Section No. 1
Bill No. 1
PRELIMINARIES

DEVELOPMENT BANK OF SOUTH AFRICA

the execution of the **works** unless due to any act or negligence of any person for whose actions the **employer** is legally liable

c. The **contractor** shall, upon receiving a **contract instruction** from the **principal agent**, cause the same to be made good in a perfect and workmanlike manner at his own cost and in default thereof the **employer** shall be entitled to cause it to be made good and to recover the cost thereof from the **contractor** or to deduct the same from amounts due to the **contractor**

d. The **contractor** shall be responsible for the protection and safety of such portions of the premises placed under his control by the **employer** for the purpose of executing the **works** until the issue of the **certificate of practical completion**

e. Where the execution of the **works** involves the risk of removal of or interference with support to adjoining properties including land or structures or any structures to be altered or added to, the **contractor** shall obtain adequate insurance and will remain adequately insured or insured to the specific limit stated in the contract against the death of or injury to persons or damage to such property consequent on such removal or interference with the support until such portion of the **works** has been completed

f. The **contractor** shall at all times proceed immediately at his own cost to remove or dispose of any debris and to rebuild, restore, replace and/or repair such property and to execute the **works**

m

10.7 High risk insurance

In the event of the project being executed in a geological area classified as a "High Risk Area", that is an area which is subject to highly unstable subsurface conditions that might result in catastrophic ground movement evident by sinkhole or doline formation the following will apply:

10.7.1 Damage to the works

The **contractor** shall, from the **commencement date** of the **works** until the date of the **certificate of practical completion** bear the full risk of and hereby indemnifies and holds harmless the **employer** against any damage

Carried to Collection

R

Section No. 1
Bill No. 1
PRELIMINARIES

DEVELOPMENT BANK OF SOUTH AFRICA

to and/or destruction of the **works** consequent upon a catastrophic ground movement as mentioned above. The **contractor** shall take such precautions and security measures and other steps for the protection of the **works** as he may deem necessary

When so instructed to do so by the **principal agent**, the **contractor** shall proceed immediately to remove and/or dispose of any debris arising from damage to or destruction of the **works** and to rebuild, restore, replace and/or repair the **works**, at the **contractor's** own costs

10.7.2 Injury to persons or loss of or damage to property

The **contractor** shall be liable for and hereby indemnifies and holds harmless the **employer** against any liability, loss, claim or proceeding arising at any time during the period of the contract whether arising in common law or by statute, consequent upon personal injuries to or the death of any person whomsoever resulting from, arising out of, or caused by a catastrophic ground movement as mentioned above

The **contractor** shall be liable for and hereby indemnifies the **employer** against any and all liability, loss, claim or proceeding consequent upon loss of or damage to any moveable or immovable or personal property or property contiguous to the **site**, whether belonging to or under the control of the **employer** or any other body or person whomsoever arising out of or caused by a catastrophic ground movement, as mentioned above, which occurred during the period of the contract

10.7.3 It is the responsibility of the **contractor** to ensure that he has adequate insurance to cover his risk and liability as mentioned in 10.7.1 and 10.7.2. Without limiting the **contractor's** obligations in terms of the contract, the **contractor** shall, within twenty-one (21) **calendar days** of the **commencement date** but before commencement of the **works**, submit to the **employer** proof of such insurance policy, if requested to do so

10.7.4 The **employer** shall be entitled to recover any and all losses and/or damages of whatever nature suffered or incurred consequent upon the **contractor's** default of his obligations as set out in 10.7.1; 10.7.2 and 10.7.3. Such losses or damages may be recovered from

Carried to Collection

R

Section No. 1
Bill No. 1
PRELIMINARIES

DEVELOPMENT BANK OF SOUTH AFRICA

the **contractor** or by deducting the same from any amounts still due under this contract or under any other contract presently or hereafter existing between the **employer** and the **contractor** and for this purpose all these contracts shall be considered one indivisible whole

13	Clause 11.0 - Liability insurances F:..... V:..... T:.....	Item
14	Clause 12.0 - Effecting insurances F:..... V:..... T:.....	Item
15	Clause 13.0 - No Clause F:..... V:..... T:.....	Item
16	Clause 14.0 - Security F: R..... V:..... T:.....	Item

Clauses 14.1 - 14.8 are amended by replacing them with the following:

14.1 In respect of contracts with a **contract sum** up to R1 million, the **security** to be provided by the **contractor** to the **employer** will be a payment reduction of five per cent (5%) of the value certified in the **payment certificate** (excluding VAT)

14.1.1 The payment reduction of the value certified in a **payment certificate** shall be *mutatis mutandi* in terms of 31.8(A)

14.1.2 The **employer** shall be entitled to recover expense and loss from the payment reduction in terms of 33.0 provided that the **employer** complies with the provisions of 33.4 in which event the **employer's** entitlement shall take precedence over his obligations to refund the payment reduction **security** or portions thereof to the **contractor**

14.2 In respect of contracts with a **contract sum** above R1 million, the **contractor** shall have the right to select the **security** to be provided in terms of 14.3, 14.4, 14.5, 14.6, or 14.7 as stated in the **schedule**. Such **security** shall be provided to the **employer** within twenty-one (21) **calendar days** from **commencement date**. Should the **contractor** fail to select the **security** to be provided

Carried to Collection

R

Section No. 1
Bill No. 1
PRELIMINARIES

DEVELOPMENT BANK OF SOUTH AFRICA

or should the **contractor** fail to provide the **employer** with the selected **security** within twenty-one (21) **calendar days** from **commencement date**, the **security** in terms of 14.7 shall be deemed to have been selected

14.3 Where **security** as a cash deposit of ten per cent (10%) of the **contract sum** (excluding VAT) has been selected:

14.3.1 The **contractor** shall furnish the **employer** with a cash deposit equal in value to ten per cent (10%) of the **contract sum** (excluding VAT) within twenty-one (21) **calendar days** from **commencement date**

14.3.2 Within twenty-one (21) **calendar days** of the date of **practical completion** of the **works** the **employer** shall reduce the cash deposit to an amount equal to three per cent (3%) of the **contract value** (excluding VAT), and refund the balance to the **contractor**

14.3.3 Within twenty-one (21) **calendar days** of the date of **final completion** of the **works** the **employer** shall reduce the cash deposit to an amount equal to one per cent (1%) of the **contract value** (excluding VAT) and refund the balance to the **contractor**

14.3.4 On the date of payment of the amount in the final **payment certificate**, the **employer** shall refund the remainder of the cash deposit to the **contractor**

14.3.5 The **employer** shall be entitled to recover expense and loss from the cash deposit in terms of 33.0 provided that the **employer** complies with the provisions of 33.4 in which event the **employer's** entitlement shall take precedence over his obligations to refund the cash deposit **security** or portions thereof to the **contractor**

14.3.6 The parties expressly agree that neither the **employer** nor the **contractor** shall be entitled to cede the rights to the deposit to any third party

14.4 Where **security** as a variable **construction guarantee** of ten percent (10%) of the **contract sum** (excluding VAT) has been selected:

14.4.1 The **contractor** shall furnish the **employer** with an acceptable variable **construction guarantee** equal

Carried to Collection

R

Section No. 1
Bill No. 1
PRELIMINARIES

DEVELOPMENT BANK OF SOUTH AFRICA

in value to ten per cent (10%) of the **contract sum** (excluding VAT) within twenty-one (21) **calendar days** from **commencement date**

14.4.2 The variable **construction guarantee** shall reduce and expire in terms of the Variable **Construction Guarantee** form included in the invitation to tender

14.4.3 The **employer** shall return the variable **construction guarantee** to the **contractor** within fourteen (14) **calendar days** of it expiring

14.4.4 Where the **employer** has a right of recovery against the **contractor** in terms of 33.0, the **employer** shall issue a written demand in terms of the variable **construction guarantee**

14.5 Where **security** as a fixed **construction guarantee** of five per cent (5%) of the **contract sum** (excluding VAT) and a five per cent (5%) payment reduction of the value certified in the **payment certificate** (excluding VAT) has been selected:

14.5.1 The **contractor** shall furnish a fixed **construction guarantee** to the **employer** equal in value to five per cent (5%) of the **contract sum** (excluding VAT)

14.5.2 The fixed **construction guarantee** shall come into force on the date of issue and shall expire on the date of the last certificate of **practical completion**

14.5.3 The **employer** shall return the fixed **construction guarantee** to the **contractor** within fourteen (14) **calendar days** of it expiring

14.5.4 The payment reduction of the value certified in a **payment certificate** shall be in terms of 31.8 (A) and 34.8

14.5.5 Where the **employer** has a right of recovery against the **contractor** in terms of 33.0, the **employer** shall be entitled to issue a written demand in terms of the fixed **construction guarantee** or may recover from the payment reduction or may do both

14.6 Where **security** as a cash deposit of five per cent (5%) of the **contract sum** (excluding VAT) and a payment reduction of five per cent (5%) of the value

Carried to Collection

R

Section No. 1
Bill No. 1
PRELIMINARIES

DEVELOPMENT BANK OF SOUTH AFRICA

certified in the **payment certificate** (excluding VAT) has been selected:

14.6.1 The **contractor** shall furnish the **employer** with a cash deposit equal in value to five per cent (5%) of the **contract sum** (excluding VAT) within twenty-one (21) **calendar days** from **commencement date**

14.6.2 Within twenty-one (21) **calendar days** of the date of **practical completion** of the **works** the **employer** shall refund the cash deposit in total to the **contractor**

14.6.3 The payment reduction of the value certified in a **payment certificate** shall be *mutatis mutandi* in terms of 31.8(A)

14.6.4 Where the **employer** has a right of recovery against the **contractor** in terms of 33.0, the **employer** may issue a written notice in terms of 33.4 or may recover from the payment reduction or may do both

14.7 Where **security** as a payment reduction of ten per cent (10%) of the value certified in the **payment certificate** (excluding VAT) has been selected:

14.7.1 The payment reduction of the value certified in a **payment certificate** shall be *mutatis mutandi* in terms of 31.8(B)

14.7.2 The **employer** shall be entitled to recover expense and loss from the payment reduction in terms of 33.0 provided that the **employer** complies with the provisions of 33.4 in which event the **employer's** entitlement shall take precedence over his obligations to refund the payment reduction or portions thereof to the **contractor**

14.8 Payments made by the guarantor to the **employer** in terms of the fixed or variable **construction guarantee** shall not prejudice the rights of the **employer** or **contractor** in terms of this **agreement**

14.9 Should the **contractor** fail to furnish the **security** in terms of 14.2, the **employer**, in his sole discretion and without notification to the **contractor**, is entitled to change the **contractor's** selected form of **security** to that of a ten per cent (10%) payment reduction of the value certified in the **payment**

Carried to Collection

R

Section No. 1
Bill No. 1
PRELIMINARIES

DEVELOPMENT BANK OF SOUTH AFRICA

certificate (excluding VAT), whereafter 14.7 shall be applicable

Execution

17 Clause 15.0 - Preparation for and execution of the works

F: R V: T:

Item

18 Clause 15.1.1 is amended by replacing it with: No Clause

Clause 15.1.2 is amended by replacing it with:
The **security** selected in terms of 14.0

Clause 15.1 is amended by the addition of the following clause:
15.1.4 An acceptable health and safety plan, required in terms of the Occupational Health and Safety Act, 1993 (Act 85 of 1993), within twenty-one (21) **calendar days** of **commencement date**

Clause 15.2.1 is amended by replacing it with the following clause:

Give the **contractor** possession of the **site** within ten (10) **working days** of the **contractor** complying with the terms of 15.1.4

m

19 Clause 16.0 - Access to the works

F: V:
T:

Item

20 Clause 17.0 - Contract instructions F:
V: T:

Item

21 Clause 17.1.11 is amended by deleting the words "and the appointment of **nominated** and **selected subcontractors**"

m

Carried to Collection

R

Section No. 1
Bill No. 1
PRELIMINARIES

DEVELOPMENT BANK OF SOUTH AFRICA

22	<p>Clause 18.0 - Setting out of the works</p> <p>The contractor shall notify the principal agent if any encroachments of adjoining foundations, buildings, structures, pavements, boundaries, etc. exist in order that the necessary arrangements may be made for the rectification of any such encroachments.</p> <p>F:..... V:..... T:.....</p>	Item		
23	<p>Clause 19.0 - Assignment</p> <p>F: V:..... T:</p>	Item		
24	<p>Clause 20.0 - Nominated subcontractors</p> <p>F:..... V:..... T:.....</p> <p>Clause 20.1.3 is amended by replacing it with the following: No clause</p> <p>Note: See item B9.1 hereinafter for adjustment of attendance on nominated subcontractors executing work allowed for under provisional sums</p>	Item		
25	<p>Clause 21.0 - Selected subcontractors</p> <p>F:..... V:..... T:.....</p>	Item		
26	<p>Clause 21 is amended by replacing it with: No clause</p>	m		
27	<p>Clause 22.0 - Employer's direct contractors:</p> <p>F:..... V:..... T:.....</p>	Item		
28	<p>Clause 23.0 - Contractor's domestic subcontractors</p> <p>F:..... V:..... T:.....</p> <p><u>Completion</u></p>	Item		
29	<p>Clause 24.0 - Practical completion</p> <p>F:..... V:..... T:.....</p>	Item		
Carried to Collection			R	
<p>Section No. 1 Bill No. 1 PRELIMINARIES</p> <p style="text-align: center;">DEVELOPMENT BANK OF SOUTH AFRICA</p>				

30	Clause 25.0 - Works completion F:..... V:..... T:.....	m	Item		
31	Clause 26.0 - Final completion F:..... V:..... T:.....		Item		
32	Clause 26.1.2 is amended by inserting "#" next to 26.1.2	m			
33	Clause 27.0 - Latent defects liability period F:..... V:..... T:.....		Item		
	Clause 27.0 is amended by the addition of the following clause: The Contractor shall attend to defects during the Defects Liability Period on a progressive basis, to the satisfaction of the Principle Agent and will not be permitted to wait until the end of the Defects Liability Period or until the amount of defects accumulate in order to attend to a comprehensive list of defects.				
34	Clause 28.0 - Sectional completion F:..... V:..... T:.....		Item		
35	Clause 29.0 - Revision of date for practical completion The removal and replacement of materials and/or workmanship which do not conform to specification or drawing shall not constitute grounds for the extension of the construction period nor for the adjustment of the contract value (Clause 29.3) F:..... V:..... T:.....		Item		
36	Clause 29.2.5 is amended by replacing it with: No clause	m			
37	Clause 30.0 - Penalty for late or non-completion F:..... V:..... T:.....		Item		
Carried to Collection				R	
Section No. 1 Bill No. 1 PRELIMINARIES					
DEVELOPMENT BANK OF SOUTH AFRICA					

Payment

38 Clause 31.0 - Interim payment

The inclusion of materials and goods stored off site in the amount authorised for payment in terms of clause 31.4 shall be at the sole discretion of the principal agent and such inclusion shall only be considered upon the provision, by the contractor, of an approved guarantee issued by a registered commercial bank. Clause 31.6.5 is therefore not applicable

Materials and goods stored off site shall not be included in the amount authorised for payment

F:..... V:.....
T:.....

Item

39 Clause 31.5.2 is amended by replacing "14.7.1" with "14.0"

Clause 31.8 is amended by replacing it with the following two alternative clauses:

Alternative A

31.8(A) Where a **security** is selected in terms of 14.1; 14.5 or 14.6, the value of the **works** in terms of 31.4.1 and **materials and goods** in terms of 31.4.2 shall be certified in full. The value certified shall be subject to the following percentage adjustments:

31.8(A).1 Ninety-five per cent (95%) of such value in interim **payment certificates** issued up to the date of **practical completion**

31.8(A).2 Ninety-seven per cent (97%) of such value in interim **payment certificates** issued on the date of **practical completion** and up to but excluding the date of **final completion**

31.8(A).3 Ninety-nine per cent (99%) of such value in interim **payment certificates** issued on the date of **final completion** and up to but excluding the final **payment certificate** in terms of 34.6

31.8(A).4 One hundred per cent (100%) of such value in

Carried to Collection

R

Section No. 1
Bill No. 1
PRELIMINARIES

DEVELOPMENT BANK OF SOUTH AFRICA

the final **payment certificate** in terms of 34.6 except where the amount certified is in favour of the **employer**. In such an event the payment reduction shall remain at the adjustment level applicable to the final **payment certificate**

Alternative B

31.8(B) Where **security** as a payment reduction in terms of 14.7 has been selected, the value of the **works** in terms of 31.4.1 and **materials and goods** in terms of 31.4.2 shall be certified in full. The value certified shall be subject to the following percentage adjustments:

31.8(B).1 Ninety per cent (90%) of such value in interim **payment certificates** issued up to the date of **practical completion**

31.8(B).2 Ninety-seven per cent (97%) of such value in interim **payment certificates** issued on the date of **practical completion** and up to but excluding the date of **final completion**

31.8(B).3 Ninety-nine per cent (99%) of such value in interim **payment certificates** issued on the date of **final completion** and up to but excluding the final **payment certificate** in terms of 34.6

31.8(B).4 One hundred per cent (100%) of such value in the final **payment certificate** in terms of 34.6 except where the amount certified is in favour of the **employer**. In such an event the payment reduction shall remain at the adjustment level applicable to the final **payment certificate**

Clause 31.12 is amended by deleting the following:

Payment shall be subject to the **employer** giving the **contractor** a tax invoice for the amount due

m

40 Clause 32.0 - Adjustment to the contract value

F:..... V:.....
T:.....

Item

Carried to Collection

R

Section No. 1
Bill No. 1
PRELIMINARIES

DEVELOPMENT BANK OF SOUTH AFRICA

41	Clauses 32.5.1, 32.5.4 and 32.5.7 are amended by the addition of the following at the end of the sentence: "due to no fault of the contractor "	m			
42	Clause 33.0 - Recovery of expense and loss F:..... V:..... T:.....		Item		
43	Clause 34.0 - Final account and final payment F:..... V:..... T:.....		Item		
44	Clause 34.1 is amended by removing "#" next to 34.1 Clause 34.2 is amended by inserting "#" next to 34.2 Clause 34.8 is amended by deleting the words "where security as a fixed construction guarantee in terms of 14.4 has been selected or where payment reduction has been applied in terms of 14.7.1" Clause 34.13 is amended by replacing "seven (7) calendar days " with "twenty-one (21) calendar days " and deleting the words "subject to the employer giving the contractor a tax invoice for the amount due"	m			
45	Clause 35.0 - Payment to other parties F:..... V:..... T:..... <u>CANCELLATION</u>		Item		
46	Clause 36.0 - Termination by employer - contractor's default F:..... V:..... T:.....		Item		
Carried to Collection					R
Section No. 1 Bill No. 1 PRELIMINARIES					
DEVELOPMENT BANK OF SOUTH AFRICA					

47	<p>Clause 36.1 is amended by the addition of the following clauses:</p> <p>36.1.3 refuses or neglects to comply strictly with any of the conditions of contract</p> <p>36.1.4 estate being sequestrated, liquidated or surrendered in terms of the insolvency laws in force within the Republic of South Africa</p> <p>36.1.5 in the judgement of the employer, has engaged in corrupt or fraudulent practices in competing for or in executing the contract</p> <p>Clause 36.0 is amended by the addition of the following clause:</p> <p>36.7 Notwithstanding any clause to the contrary, on cancellation of this agreement either by the employer or the contractor; or for any reason whatsoever, the contractor shall on written instruction, discontinue with the works on a date stated and withdraw himself from the site. The contractor shall not be entitled to refuse to withdraw from the works on the grounds of any lien or right of retention or on the grounds of any other right whatsoever</p>	m			
48	<p>Clause 37.0 - Termination by employer - loss and damage F:..... V:..... T:.....</p>		Item		
49	<p>Clause 37.3.5 is amended by replacing "ninety (90)" with "one hundred and twenty (120)"</p> <p>Clause 37.0 is amended by the addition of the following clause:</p> <p>37.5 Notwithstanding any clause to the contrary, on cancellation of this agreement either by the employer or the contractor; or for any reason whatsoever, the contractor shall on written instruction, discontinue with the works on a date stated and withdraw himself from the site. The contractor shall not be entitled to refuse to withdraw from the works on the grounds of any lien or right of retention or on the grounds of any other right whatsoever</p>	m			
Carried to Collection					R
<p>Section No. 1 Bill No. 1 PRELIMINARIES</p> <p style="text-align: center;">DEVELOPMENT BANK OF SOUTH AFRICA</p>					

50	Clause 38.0 - Termination by contractor - employer's default F:..... V:..... T:.....	Item		
51	Clause 38.5.4 is amended by replacing "ninety (90)" with "one hundred and twenty (120)" Clause 38.0 is amended by the addition of the following clause: 38.7 Notwithstanding any clause to the contrary, on cancellation of this agreement either by the employer or the contractor ; or for any reason whatsoever, the contractor shall on written instruction, discontinue with the works on a date stated and withdraw himself from the site . The contractor shall not be entitled to refuse to withdraw from the works on the grounds of any lien or right of retention or on the grounds of any other right whatsoever	m		
52	Clause 39.0 - Termination - cessation of the works F:..... V:..... T:.....	Item		
53	Clause 39.3.5 is amended by the addition of the following at the end of the sentence: "within one hundred and twenty (120) working days of completion of such a report"	m		
	<u>Dispute</u>			
54	Clause 40.0 - Settlement of disputes F:..... V:..... T:.....	Item		
Carried to Collection			R	
Section No. 1 Bill No. 1 PRELIMINARIES				
DEVELOPMENT BANK OF SOUTH AFRICA				

- 55 Clause 40.2.2 is amended by replacing "one (1) year" with "three (3) years"
- Clause 40.6 is amended by removing the reference to:
No clause
- Clause 40.7.1 is amended by replacing "(10)" with "(15)" and by the addition of the following:
- Whether or not mediation resolves the dispute, the parties shall bear their own costs concerning the mediation and equally share the costs of the **mediator** and related costs

m

SUBSTITUTE PROVISIONS

- 56 Clause 41.0 - STATE CLAUSES

Item

CONTRACT VARIABLES

- 57 Clause 42.0 - THE SCHEDULE (DPW-04EC)

Tenderers are referred to the Contract Data DPW-04(EC) for variables pertaining to this contract

F:..... V:.....
T:.....

Item

The required information of the contracting parties and the amount of the accepted contract sum shall be inserted in the contractual agreement for signature of the agreement by the contracting parties

Carried to Collection

R

Section No. 1
Bill No. 1
PRELIMINARIES

DEVELOPMENT BANK OF SOUTH AFRICA

SECTION B - JBCC PRELIMINARIES

Definitions and interpretation

58 Clause 1.0 - Definitions and interpretation
F:..... V:.....
T:.....

Item

See also clause A1.0 of Section A for additional and/or amended definitions which shall apply equally to this Section

Documents

59 Clause 2.1 - Checking of documents
F:..... V:.....
T:.....

Item

60 Clause 2.2 - Provisional bills of quantities
F:..... V:.....
T:.....

Item

61 Clause 2.3 - Availability of construction documentation
F:..... V:.....
T:.....

Item

62 Clause 2.4 Interests of agents
F:..... V:.....
T:.....

Item

63 Clause 2.5 Priced documents
F:..... V:.....
T:.....

Item

Carried to Collection

R

Section No. 1
Bill No. 1
PRELIMINARIES

DEVELOPMENT BANK OF SOUTH AFRICA

64	<p>Clause 2.6 Tender submission</p> <p>Clause 2.6 is amended by replacing "JBCC Form of Tender" with "Form of Offer and Acceptance DPW-07(EC)"</p> <p>F:..... V:..... T:.....</p> <p><u>THE SITE</u></p>	Item		
65	<p>Clause 3.1 Defined works area</p> <p>F:..... V:..... T:.....</p>	Item		
66	<p>Clause 3.2 Geotechnical investigation</p> <p>F:..... V:..... T:.....</p>	Item		
67	<p>Clause 3.3 Inspection of the site</p> <p>F:..... V:..... T:.....</p>	Item		
68	<p>Clause 3.4 Existing premises occupied</p> <p>F:..... V:..... T:.....</p>	Item		
69	<p>Clause 3.5 - Previous work - dimensional accuracy</p> <p>F:..... V:..... T:.....</p>	Item		
70	<p>Clause 3.6 - Previous work - defects</p> <p>F:..... V:..... T:.....</p>	Item		
Carried to Collection			R	
<p>Section No. 1 Bill No. 1 PRELIMINARIES</p> <p style="text-align: right;">DEVELOPMENT BANK OF SOUTH AFRICA</p>				

71	Clause 3.7 Services - known F:..... V:..... T:.....	Item
72	Clause 3.8 Services - unknown F:..... V:..... T:.....	Item
73	Clause 3.9 Protection of trees F:..... V:..... T:.....	Item
74	Clause 3.10 Articles of value F:..... V:..... T:.....	Item
75	Clause 3.11 - Inspection of adjoining properties F:..... V:..... T:.....	Item
<u>MANAGEMENT OF CONTRACT</u>		
76	Clause 4.1 Management of the works F:..... V:..... T:.....	Item
77	Clause 4.2 Programme for the works F:..... V:..... T:.....	Item
78	Clause 4.3 Progress meetings F:..... V:..... T:.....	Item
79	Clause 4.4 Technical meetings F:..... V:..... T:.....	Item
80	Clause 4.5 Labour and plant records F:..... V:..... T:.....	Item

Carried to Collection

R

Section No. 1
Bill No. 1
PRELIMINARIES

DEVELOPMENT BANK OF SOUTH AFRICA

Samples, shop drawings and manufacturer's instructions

- | | | |
|----|--|------|
| 81 | Clause 5.1 - Samples of materials F:.....
V:..... T:..... | Item |
| 82 | Clause 5.2 - Workmanship samples F:.....
V:..... T:..... | Item |
| 83 | Clause 5.3 - Shop drawings
F:..... V:.....
T:..... | Item |
| 84 | Clause 5.4 - Compliance with manufacturer's instructions
F:..... V:.....
T:..... | Item |

TEMPORARY WORKS AND PLANT

- | | | |
|----|--|------|
| 85 | Clause 6.1 Deposits and fees
F:..... V:.....
T:..... | Item |
| 86 | Clause 6.2 Enclosure of the works
F:..... V:.....
T:..... | Item |
| 87 | Clause 6.3 Advertising
F:..... V:.....
T:..... | Item |
| 88 | Clause 6.4 Plant, equipment, sheds and offices
F:..... V:.....
T:..... | Item |
| 89 | Clause 6.5 Main notice board
F:..... V:.....
T:..... | Item |
| 90 | Clause 6.6 Subcontractors' notice board
F:..... V:.....
T:..... | Item |

Carried to Collection

Section No. 1
Bill No. 1
PRELIMINARIES

DEVELOPMENT BANK OF SOUTH AFRICA

R

Temporary services

The employer does not warrant that any supply or service that may exist is adequate for the proper execution of the works. In the case of such supply or service being inadequate or non existing, the contractor shall provide adequate supply and services at his own cost

91	Clause 7.1 Location F: V:..... T:	Item
92	Clause 7.2 - Water F: V:..... T:	Item
93	Clause 7.3 - Electricity F: V:..... T:	Item
94	Clause 7.4 - Telecommunication facilities F: R V:..... T:	Item
95	Clause 7.5 - Ablution facilities F:..... V:..... T:	Item

Prime cost amounts

96	Clause 8.1 - Responsibility for prime cost amounts F:..... V:..... T:.....	Item
----	--	------

Attendance on n/s subcontractors

97	Clause 9.1 General attendance F: V:..... T:	Item
98	Clause 9.2 - Special attendance F:..... V:..... T:.....	Item

Carried to Collection

R

Section No. 1
Bill No. 1
PRELIMINARIES

DEVELOPMENT BANK OF SOUTH AFRICA

99	<p>Clause 9.3 Commissioning - fuel, water and electricity F: V: T:</p> <p><u>FINANCIAL ASPECTS</u></p>	Item		
100	<p>Clause 10.1 Statutory taxes, duties and levies F: V: T:</p>	Item		
101	<p>Clause 10.2 Payment for preliminaries F: V: T:</p>	Item		
102	<p>Clause 10.3 Adjustment of preliminaries</p> <p>Clauses B10.3.1 and B10.3.2 are amended by replacing "within fifteen (15) working days of taking possession of the site" with "when submitting his priced bills of quantities / lump sum document"</p> <p>F: V: T:</p>	Item		
103	<p>Clause 10.4 Payment certificate cash flow F: V: T:</p> <p><u>General</u></p>	Item		
104	<p>Clause 11.1 - Protection of the works F: V: T:</p>	Item		
105	<p>Clause 11.2 - Protection/isolation of existing/sectionally occupied works</p> <p>F: V: T:</p>	Item		
106	<p>Clause 11.3 - Security of the works</p> <p>F: V: T:</p>	Item		
Carried to Collection			R	
<p>Section No. 1 Bill No. 1 PRELIMINARIES</p> <p style="text-align: right;">DEVELOPMENT BANK OF SOUTH AFRICA</p>				

107	Clause 11.4 - Notice before covering work F:..... V:..... T:.....	Item		
108	Clause 11.5 - Disturbance F:..... V:..... T:.....	Item		
109	Clause 11.6 - Environmental disturbance F:..... V:..... T:	Item		
110	Clause 11.7 - Works cleaning and clearing F:..... V:..... T:	Item		
111	Clause 11.8 - Vermin F:..... V:..... T:.....	Item		
112	Clause 11.9 - Overhand work F:..... V:..... T:.....	Item		
113	Clause 11.10 Instruction manuals and guarantees F:..... V:..... T:.....	Item		
114	Clause 11.11 As built information F:..... V:..... T:.....	Item		
115	Clause 11.12 Tenant installations F:..... V:..... T:.....	Item		
	<u>Schedule of variables</u>			
116	Clause 12.1 Schedule of variables	Item		
Carried to Collection			R	
Section No. 1 Bill No. 1 PRELIMINARIES				
DEVELOPMENT BANK OF SOUTH AFRICA				

This **schedule** contains all variables referred to in this document and is divided into pre-tender and post-tender categories. The pre-tender category must be completed in full and included in the tender documents. Both the pre-tender and post-tender categories form part of these **Preliminaries**

Spaces requiring information must be filled in, shown as "not applicable" or deleted and not left blank. Where choices are offered, the non-applicable items are to be deleted. Where insufficient space is provided the information should be annexed hereto and cross-referenced to the applicable clause of the **schedule**. Key cross reference clauses are italicised in [] brackets

12.1.1 - Provisional bills of quantities

[2.2] The quantities are provisional

Yes/No

12.1.2 - Availability of construction documentation

[2.3] Construction documentation is complete

Yes/ No

12.1.3 Interests of agents [2.4]

Details:

12.1.4 Defined works area [3.1]

Details:

12.1.5 Geotechnical investigation [3.2]

Details:

12.1.6 Existing premises occupied

[3.4] Specific requirements:

12.1.7 - Previous work - dimensional accuracy

[3.5] Details:

12.1.8 - Previous work - defects [clause 3.5]

12.1.9 Services - known

[3.7] Details:

Carried to Collection

R

Section No. 1

Bill No. 1

PRELIMINARIES

DEVELOPMENT BANK OF SOUTH AFRICA

12.1.10 Protection of trees
[3.9] Specific requirements:

12.1.11 Inspection of adjoining properties
[3.11] Specific requirements:

12.1.12 Enclosure of the works
[6.2] Specific requirements:

12.1.13 Offices
[6.4.3] Specific requirements:
The **contractor** shall provide, maintain and remove on completion of the works an office for the exclusive use of the **principal agent**, minimum size 4 x 3 x 3m high internally, suitably insulated and ventilated, provided with electric lighting and fitted with boarded floor, desk, chair, drawing stool, drawing board and lock-up drawers for drawings. The office shall be kept clean and fit for use at all times

12.1.14 Main notice board
[6.5] Specific requirements:
The **contractor** shall provide, erect where directed, maintain and remove on completion of the **works** a notice board size 3 x 3m as type Drawing GEN 063, constructed of suitable boarding with flat smooth surface and with edging bead 19mm thick round outer edges and projecting 12mm from face of boarding and rounded on front edge. The board shall be securely fixed to hoarding, where hoarding is provided, or fixed to and including a suitable supporting structure of timber or tubular posts and braces. The board is to be painted ivory white and the bead and 12mm wide dividing lines dark green. All wording shall be inscribed in dark green as per the coat of arms for SA. All wording shall be inscribed in dark green painted sans serif lettering

12.1.15 Subcontractors' notice board
[6.6] *A notice board is required*
YES/NO

Specific requirements:

Carried to Collection

R

Section No. 1
Bill No. 1
PRELIMINARIES

DEVELOPMENT BANK OF SOUTH AFRICA

12.1.16 Water
[7.2] Option A (by **contractor**) YES/NO

Option B (by **employer** - free of charge)
YES/NO

Option C (by **employer** - metered)
YES/NO

12.1.17 Electricity
[7.3] Option A (by **contractor**)
YES/NO

Option B (by **employer** - free of charge)
YES/NO

Option C (by **employer** - metered)
YES/NO

12.1.18 Telecommunications
[7.4] Telephone YES/NO

Facsimile YES/NO

E-mail YES/NO

12.1.19 Ablution facilities
[7.5] Option A (by **contractor**)
YES/NO

Option B (by **employer**)
YES/NO

12.1.20 Protection of existing/sectionally occupied works
[11.2] Protection is required
YES/NO

Carried to Collection

R

Section No. 1
Bill No. 1
PRELIMINARIES

DEVELOPMENT BANK OF SOUTH AFRICA

12.1.21 Special attendance
[9.2] **Subcontractor** (1) details:

Subcontractor (2) details:

Subcontractor (3) details:

Subcontractor (4) details:

12.1.22 Protection of the works
[11.1] Specific requirements:

12.1.23 Disturbance
[11.5] Specific requirements:
The **contractor** shall keep the site, structures, etc well watered during operations to prevent dust and shall provide and erect and remove on completion of the **works** all necessary temporary dust screens all to the satisfaction of the **principal agent**

12.1.24 Environmental disturbance
[11.6] Specific requirements:

12.2 POST-TENDER INFORMATION

12.2.1 Payment of preliminaries
[10.2] Option A (prorated)
YES/NO

12.2.2 Adjustment of preliminaries
[10.3] Option A (three categories)
YES/NO

Option B (detailed breakdown)
YES/NO

12.2.3 Additional agreed preliminaries items
Details:

Carried to Collection

Section No. 1
Bill No. 1
PRELIMINARIES

DEVELOPMENT BANK OF SOUTH AFRICA

R

SECTION C - SPECIFIC PRELIMINARIES

Section C contains specific preliminary items which apply to this contract except where N/A (Not Applicable) appears against an item

117 **C1.0 CONTRACT DRAWINGS**

** Select relevant paragraph and delete whichever is not applicable depending on whether the contract is based on a **bills of quantities** or **lump sum document***

* The drawings issued with the tender documents do not comprise the complete set but serve as a guide only for tendering purposes and for indicating the scope of the work to enable the tenderer to acquaint himself with the nature and extent of the **works** and the manner in which they are to be executed

* A full set of drawings is issued with the tender documents indicating the full scope of the work to enable the tenderer to acquaint himself with the nature and extent of the **works** and the manner in which they are to be executed

Should any part of the drawings not be clearly understood by the tenderer he shall, before submitting his tender, obtain clarification in writing from the **principal agent**

F:..... V:.....
T:.....

Item

Carried to Collection

R

Section No. 1
Bill No. 1
PRELIMINARIES

DEVELOPMENT BANK OF SOUTH AFRICA

118 C2.0 GENERAL PREAMBLES

The document "Specification of Materials and Methods to be used (PW371)" is obtainable on the Department's website (<http://www.publicworks.gov.za/> under "Consultants Guidelines"), and shall be read in conjunction with the **bills of quantities / lump sum document** and be referred to for the full descriptions of work to be done and materials to be used

F:..... V:.....
T:.....

Item

119 C3.0 TRADE NAMES

Wherever a trade name for any product has been described in the **bills of quantities / lump sum document**, the tenderer's attention is drawn to the fact that any other product of equal quality may be used subject to the written approval of the **principal agent** being obtained prior to the closing date for submission of tenders

If prior written approval for an alternative product is not obtained, the product described shall be deemed to have been tendered for

F:..... V:.....
T:.....

Item

Carried to Collection

R

Section No. 1
Bill No. 1
PRELIMINARIES

DEVELOPMENT BANK OF SOUTH AFRICA

120 **C4.0 IMPORTED MATERIALS AND EQUIPMENT**

Where imported items are listed in the tender documents, the tenderer shall provide all the information called for, failing which the price of any such item, materials or equipment shall be excluded from currency fluctuations. (refer to Schedule of Imported Materials and Equipment DPW-23(EC) to be completed by tenderer)

Notwithstanding any provisions elsewhere regarding the adjustment of contract prices, the price of any item, material or equipment listed in terms of this clause shall be excluded from the Contract Price Adjustment Provisions (if applicable)

F:..... V:.....
T:.....

Item

121 **C5.0 VIEWING THE SITE IN SECURITY AREAS**

The **site** is situated in a security area and the tenderer must arrange with the unit commander or other responsible officer to obtain permission to enter the **site** for tendering purposes

F:..... V:.....
T:.....

Item

122 **C6.0 COMMENCEMENT OF WORKS IN SECURITY AREAS**

As the **works** falls within a security area the **contractor** must give the unit commander or other responsible officer notice before commencement of the **works**. Should the **contractor** fail to make such arrangements, admission to the **site** may be refused and any additional costs will be for the **contractor's** account

F:..... V:.....
T:.....

Item

Carried to Collection

R

Section No. 1
Bill No. 1
PRELIMINARIES

DEVELOPMENT BANK OF SOUTH AFRICA

123 C7.0 ENTRANCE PERMITS TO SECURITY AREAS

As the **works** falls within a security area the **contractor** shall obtain entrance permits for his personnel and workmen entering the area and shall comply with all regulations and instructions which may be issued from time to time regarding the protection of persons and property under the control of the Defence Force, Police or chief security officer

F:..... V:.....
T:.....

Item

124 C8.0 SECURITY CHECK OF PERSONNEL

The **principal agent** may require the **contractor** to have his personnel and workmen, or a certain number of them, security classified

In the event of the **principal agent** requesting the removal of a person or persons from the **works** for security reasons, the **contractor** shall do so forthwith and shall thereafter ensure that such person or persons are denied access to the **works** and the **site** and/or to any document or information relating to the **works**

F:..... V:.....
T:.....

Item

Carried to Collection

R

Section No. 1
Bill No. 1
PRELIMINARIES

DEVELOPMENT BANK OF SOUTH AFRICA

125

**C9.0 PROHIBITION ON TAKING OF
PHOTOGRAPHS**

In terms of article 119 of the Defence Act, 44 of 1957, it is prohibited to sketch or to take photographs of any military site or installation or any building or civil works thereon or to be in possession of a camera or other apparatus used for taking of photographs except when authorized thereto by or on behalf of the Minister

The same prohibition is also applicable to all correctional institutions in terms of article 44.1(e) of the Correctional Services Act 8 of 1959

F:..... V:.....
T:.....

Item

Carried to Collection

R

Section No. 1
Bill No. 1
PRELIMINARIES

DEVELOPMENT BANK OF SOUTH AFRICA

126	<p>C10.0 HIV/AIDS AWARENESS</p> <p>It is required of the contractor to thoroughly study the HIV/AIDS Specification (PW 1544) of the Department that must be read together with and is deemed to be incorporated under this Section of the bills of quantities / lump sum document. Provision for pricing of HIV/AIDS awareness is made under items C10.1 to C10.5 hereafter and it is explicitly pointed out that all requirements of the aforementioned specification are deemed to be priced hereunder, as the said items represent the only method of measurement and no additional items or extras to the contract in this regard shall be entertain</p> <p>The contractor must take note that compliance with the HIV/AIDS Specification is compulsory. In the event of partial or total non-compliance, the principal agent, notwithstanding the provisions of clause A 31.0 of Section A or any other clause to the contrary, reserves the right to delay issuing any progress payment certificate until the contractor provides satisfactory proof of compliance. The contractor shall not be entitled to any compensation of whatsoever nature, including interest, due to such delay of payment</p> <p>F:..... V:..... T:.....</p>	Item			
127	<p>C10.1 AWARENESS CHAMPION</p> <p>Selection, appointment, briefing and making available of an Awareness Champion including provision of all relevant services, all in accordance with the HIV/AIDS Specification</p> <p>F:..... V:..... T:.....</p>	Item			
Carried to Collection					R
<p>Section No. 1 Bill No. 1 PRELIMINARIES</p> <p>DEVELOPMENT BANK OF SOUTH AFRICA</p>					

128	<p>C10.2 AWARENESS WORKSHOPS</p> <p>Selection and appointment of a competent Service Provider approved by the principal agent, provision of a Service Provider Workshop Plan and a suitable venue, conducting of awareness workshops by means of traditional and/or modern multi- media techniques, including follow-up courses, making available all tuition material and performing assessment procedures, all in accordance with the HIV/AIDS Specification</p> <p>F:..... V:..... T:.....</p>	Item		
129	<p>C10.3 POSTERS, BOOKLETS, VIDEOS, ETC.</p> <p>Provision, displaying, maintaining and replacing when necessary of four plastic laminated posters, booklets and educational videos, etc. for the duration of the construction period, all in accordance with the HIV/AIDS Specification</p> <p>F:..... V:..... T:.....</p>	Item		
130	<p>C10.4 ACCESS TO CONDOMS</p> <p>Provision and maintenance of condom dispensers fixed in position, including male and female condoms, replenishing male and female condoms on a daily basis as required for the duration of the construction period, all in accordance with the HIV/AIDS Specification</p> <p>F:..... V:..... T:.....</p>	Item		
Carried to Collection			R	
<p>Section No. 1 Bill No. 1 PRELIMINARIES</p>				
DEVELOPMENT BANK OF SOUTH AFRICA				

131

C10.5 MONITORING

Monitoring HIV/AIDS awareness of workers, providing the **principal agent** with access to information including making available all reports, thoroughly completed and reflecting the correct information, for the duration of the **construction period** and close out, all in accordance with the HIV/AIDS Specification

F:..... V:.....
T:.....

Item

Carried to Collection

R

Section No. 1
Bill No. 1
PRELIMINARIES

DEVELOPMENT BANK OF SOUTH AFRICA

132

C11.0 OCCUPATIONAL HEALTH AND SAFETY ACT

The **contractor** shall comply with all the requirements set out in the Construction Regulations, 2003 issued under the Occupational Health and Safety Act, 1993 (Act No 85 of 1993)

It is required of the **contractor** to thoroughly study the Health and Safety Specification that must be read together with and is deemed to be incorporated under this Section of the **bills of quantities / lump sum document**

The **contractor** must take note that compliance with the Occupational Health and Safety Act, Construction Regulations and Health and Safety Specification is compulsory. In the event of partial or total non-compliance, the **principal agent**, notwithstanding the provisions of clause A31.0 of Section A or any other clause to the contrary, reserves the right to delay issuing any progress **payment certificate** until the **contractor** provides satisfactory proof of compliance. The **contractor** shall not be entitled to any compensation of whatsoever nature, including interest, due to such delay of payment

Provision for pricing of the Occupational Health and Safety Act, Construction Regulations and Health and Safety Specification is made under this clause and it is explicitly pointed out that all requirements of the aforementioned are deemed to be priced hereunder and no additional claims in this regard shall be entertained

F:..... V:.....
T:.....

Item

Carried to Collection

R

Section No. 1
Bill No. 1
PRELIMINARIES

DEVELOPMENT BANK OF SOUTH AFRICA

133	<p>C11.1 NOTIFICATION OF CONSTRUCTION WORK (Construction Regulation 3)</p> <p>The Contractor shall, before commencing work, notify the Department of Labour of the intended construction work in terms of Regulation 3. The Contractor shall submit the notification in writing, on the appropriate form, prior to commencement of work</p> <p>F:..... V:..... T:.....</p>	Item		
134	<p>C11.2 HEALTH AND SAFETY PLAN (Construction Regulation 5.4)</p> <p>The Contractor shall provide and demonstrate to the Principal Agent a suitable and sufficiently documented health and safety plan based on the Act, Construction Regulations and the health and safety specification, which shall be applied from the date of commencement of and for the duration of the construction work. The Contractor shall ensure that a copy of the health and safety plan is available on request to an employee, inspector, sub contractor or principal agent all in terms of Regulation 5</p> <p>F:..... V:..... T:.....</p>	Item		
135	<p>C11.3 REGISTRATION WITH THE COMPENSATION FUND (Construction Regulation 5.3 f)</p> <p>The Contractor shall provide proof of his registration and good standing with the Compensation Fund or a licensed compensation insurer prior to the commencement of work</p> <p>F:..... V:..... T:.....</p>	Item		
Carried to Collection			R	
Section No. 1 Bill No. 1 PRELIMINARIES				
DEVELOPMENT BANK OF SOUTH AFRICA				

136 C11.4 HEALTH AND SAFETY FILE (Construction Regulation 5.7)

The Contractor shall ensure that a health and safety file, which shall include all documentation required in terms of the health and safety specification, the Act and the Construction Regulations, is opened and kept on site and made available to the Principal Agent or Inspector upon request. Upon completion of the works, the Contractor shall hand over a consolidated health and safety file to the principal agent

F:..... V:.....
T:.....

Item

137 C11.5 SUPERVISION OF CONSTRUCTION WORK (SAFETY OFFICER) (Construction Regulation 6)

The Contractor shall appoint a full-time competent employee in writing as the construction supervisor, with the duty of supervising the construction work.
The Contractor shall appoint a full-time or part-time construction safety officer in writing to assist in the control of all safety related aspects on the site. Such appointments are required to ensure that at all times the requirements of the Act and Construction Regulations are adhered to. Refer to Regulation 6

F:..... V:.....
T:.....

Item

Carried to Collection

R

Section No. 1
Bill No. 1
PRELIMINARIES

DEVELOPMENT BANK OF SOUTH AFRICA

138 C11.6 RISK ASSESSMENT AND SAFETY POLICY
(Construction Regulation 7)

Before commencing work the Contractor shall cause a risk assessment to be performed by a competent person appointed in writing and the risk assessment shall form part of the health and safety plan. A copy of the risk assessment shall be available on site at all times for inspection.

The Contractor shall at all time carry out the works in a manner to avoid the risk of bodily harm to persons or risk of damage to any property. He shall take all precautions regarding training of employees in any hazards and the related work procedures, health and safety induction training of employees, visitors or any other persons entering the site and provide personal protective equipment to all employees and visitors to site which are necessary and adequate to eliminate any conditions which contribute to the risk of injury to persons or damage to property in terms of Regulation 7

F: V:
T:

Item

139 C11.7 SIGNIFICANT HAZARDA IDENTIFICATION
RISK ASSESSMENT PREPARED BY THE DESIGN
CONSULTANTS

The contractor shall allow for additional financial provision, if any, to take the necessary precautions regarding the significant hazards and risks identified and assessed by the design consultants

F: V:
T:

Item

Carried to Collection

R

Section No. 1
Bill No. 1
PRELIMINARIES

DEVELOPMENT BANK OF SOUTH AFRICA

140	<p>C11.8 ADDITIONAL FINANCIAL PROVISION</p> <p>The Contractor shall allow for additional financial provision, if any, to comply with the requirements of the Occupational Health and Safety Act (Act No 85 of 1993) and the Construction Regulations issued there under which have not been specifically elsewhere provided</p> <p>F:..... V:..... T:.....</p>	Item		
141	<p>C11.9 FALL PROTECTION PLAN (Construction Regulation 8)</p> <p>The contractor shall, before commencing any construction work submit a fall protection plan identified all steps to be taken in order to ensure the continued adherence to the fall protection plan and shall include a risk assessment of all work carried out from an relevant position. The fall protection plan shall form part of the health and safety plan and file</p> <p>F:..... V:..... T:.....</p>	Item		
142	<p>C11.10 PHYSICAL AND PSYCHOLOGICAL FITNESS (Construction Regulation 8.2(b))</p> <p>The contractor and sub-contractors shall before commencing any construction work submit proof of his employees that shall carried out work from an elevated position their physical and psychological fitness. And shall be recorded in the health and safety file</p> <p>F:..... V:..... T:.....</p>	Item		
Carried to Collection			R	
<p>Section No. 1 Bill No. 1 PRELIMINARIES</p> <p style="text-align: right;">DEVELOPMENT BANK OF SOUTH AFRICA</p>				

143	<p>C11.11 CONSTRUCTION VEHICLES AND MOBILE PLANT (Construction Regulation 21)</p> <p>The contractor and sub-contractors shall ensure that all operated workers received training and been certified competent to operate such vehicle, and are physical and psychological fit to operate such construction vehicles and mobile plants. And shall be recorded in the health and safety file</p> <p>F:..... V:..... T:.....</p>	Item		
144	<p>C11.12 TRAINING (Construction Regulation 8 (c))</p> <p>The contractor and sub-contractors shall, before commencing any construction work, submit his training program of all his employees. This program shall form part of the health and safety plan</p> <p>F:..... V:..... T:.....</p>	Item		
145	<p>C11.13 DEMOLITION WORK (Construction Regulation 12)</p> <p>The contractor shall, before any demolition work shall be carried out, submit all method of demolition to be used. This method shall form part of the health and safety plan and file</p> <p>F:..... V:..... T:.....</p>	Item		
Carried to Collection			R	
<p>Section No. 1 Bill No. 1 PRELIMINARIES</p>				
DEVELOPMENT BANK OF SOUTH AFRICA				

146

C11.14 REMOVAL AND DISPOSAL OF ASBESTOS MATERIAL (Asbestos Regulation)

The principle contractor shall appoint a contractor that is registered with the

Department of Labour. The contractor must allow for;

NOTIFICATION OF ASBESTOS PROCESSING
PERSONAL PROTECTIVE EQUIPMENT PACKAGING
AND TRANSPORT AND STORAGE TO DISPOSAL
SITE

DEMOLITION WORK OF SHEETS LABELLING AND INFORMATION

F:..... V:.....

T:.....

Item

SUMMARY OF CATEGORIES

Category : Fixed R.....

Category : Value R

Category : Time R

Carried to Collection

R

Section No. 1

Bill No. 1

PRELIMINARIES

DEVELOPMENT BANK OF SOUTH AFRICA

Section No. 1

Bill No. 1

PRELIMINARIES

COLLECTION

Total Brought Forward from Page No.

**Page
No**

Amount

1

2

3

4

5

6

7

8

9

10

11

12

13

14

15

16

17

18

19

Carried Forward

R

Section No. 1

Bill No. 1

PRELIMINARIES

DEVELOPMENT BANK OF SOUTH AFRICA

Section No. 1			
Bill No. 1			
PRELIMINARIES			
<u>COLLECTION</u>			
	Page No	Amount	
Brought Forward		R	
Total Brought Forward from Page No.	20		
	21		
	22		
	23		
	24		
	25		
	26		
	27		
	28		
	29		
	30		
	31		
	32		
	33		
	34		
	35		
	36		
	37		
Carried Forward		R	
Section No. 1			
Bill No. 1			
PRELIMINARIES			
DEVELOPMENT BANK OF SOUTH AFRICA			

SUPPLEMENTARY PREAMBLES

STRUCTURAL WORK TO BE DEMOLISHED:

Where structures which support existing roof structures are to be demolished the contractor must provide temporary support until new supporting structures are in place.

OLD MATERIALS TO BECOME THE PROPERTY OF THE CONTRACTOR:

Old materials from alterations, except where described to be re-used or handed over, become the property of the contractor who must allow credit for same in the Final Summary.

OLD MATERIALS TO BE CARTED AWAY:

Old materials from the alteration, except where described to be re-used or handed over, as well as all rubbish, etc., must be regularly carted from the site and not be allowed to accumulate on or around the site.

OLD MATERIALS NOT TO BE RE-USED:

None of the old materials are to be used for new work except where specifically described being set aside for re-use.

HANDING OVER OF MATERIALS:

Where certain materials or articles from demolitions or articles are described as to be handed over by the Contractor to the Regional Representative or Representative/Agent, such materials or articles shall be properly stored by the contractor, until handing over thereof. The contractor must obtain an official receipt listing the contractor fails to submit the submit the receipt when requested, it shall be deemed that the materials or articles are still in his possession and he will be held liable to the Department for the full replacement value thereof, which amount will be deducted from any monies due to the contractor.

Carried to Collection

Section No. 2
Bill No. 1
ALTERATIONS

DEVELOPMENT BANK OF SOUTH AFRICA

R

DEALING WITH HAZARDOUS MATERIALS

All hazardous materials, e.g. Asbestos, etc. must be removed and disposed off site by a specialist firm as per government regulations and environmental laws.

ALTERATIONS AND DEMOLISHING

All works demolished or removed, surfaces shall be prepare to new.

Allow for the following requirements to the satisfaction of the Principal Agent

Site visit

Tenderers are to visit and view the site and existing structures to be demolished to thoroughly acquaint themselves with the nature of demolitions, the nature and extent of the work and the conditions under which the works are to be done

Existing structures

In taking down and removing existing work, the utmost care shall be observed to prevent any structural or other damage to the adjoining buildings and the Contractor shall provide all shoring, needling, strutting, etc. to ensure the stability of all structures during the alteration work. Any damage, deforming and/or defaced to the structure and/or building as well as the rectification of same will be for the Contractor's account.

Carried to Collection

Section No. 2
Bill No. 1
ALTERATIONS

DEVELOPMENT BANK OF SOUTH AFRICA

R

Existing Services

Special care shall be exercised during the progress of the work to ensure that electrical installation, water supply pipes, telephone and other services which may be encountered are not interfered with and notice shall be given to the Representative Agent if any disconnection or alterations become necessary. Any damage to such services shall be to the contractors account

Dust and noise

The Contractor is to take all necessary precautions, to minimise noise levels and frequently watering of the works to minimise any nuisance from dust and to ensure the least interference with the general routine of the occupants and operation of the premises including all necessary labour, materials, etc. for so doing and

Disposal of debris

The Contractor shall be responsible for the regular cleaning away all rubble, debris, rubbish, unusable materials, etc. as the work proceeds and for leaving the works in a clean and satisfactory state upon completion suitable for use and occupation, including all necessary labour, materials or plant, etc. for so doing

Old materials

Old materials from the alterations, except where described shall remain the property of the client.

Old materials to be carted away

Old materials from the alterations, except where described to be re-used or handed over, as well as all rubbish, etc. must regularly be carted away from site and not be allowed to accumulate on or around the site.

Carried to Collection

R

Section No. 2
Bill No. 1
ALTERATIONS

DEVELOPMENT BANK OF SOUTH AFRICA

Handing over of materials

Where certain materials or articles from demolitions or alterations are described as to be handed over by the Contractor to the Representative/ Agent, such materials or articles shall be properly stored by the Contractor until handing over thereof. The Contractor must obtain an official receipt listing materials or articles and dates of handing over. If the Contractor fails to submit the receipt when requested, it shall be deemed that the materials or articles are still in his possession and he will be held liable to the Client for the full replacement value thereof, which amount will be deducted from any monies due to the Contractor.

Temporary support to openings through existing walls

Making openings, altering openings in existing walls and removing lintels above existing openings shall be done with the utmost care to prevent any structural damage. All necessary supports, propping, shoring, needling strutting, turning pieces, etc. to wall openings is deemed to be included in the Contractor's rates.

Electrical And Mechanical

Where items include for taking down electrical and mechanical fittings the disconnection and making safe electrically is deemed to be included. Contractor to note items with barcodes (asset numbers) cannot be removed without prior arrangement with authorities

NOTE:-

Contractor to note that items with barcodes, cannot be disposed or removed from site prior to arranging with Client

TEMPORARY BARRIERS, SCREENS, ETC

Temporary barriers, screens, etc including removal on completion

1	Barrier 3000mm high separating main building from occupied buildings, formed of galvanised steel channel section rails and studs filled with minimum 12,7mm timber panels, including corners, ends, etc	m	240
---	---	---	-----

Carried to Collection

R

Section No. 2
Bill No. 1
ALTERATIONS

DEVELOPMENT BANK OF SOUTH AFRICA

DEALING WITH HAZARDOUS MATERIALS

SUPPLEMENTARY PREAMBLES

REMOVAL OF EXISTING WORK

**DEMOLITION WORK (REGULATION 21
ASBESTOS REGULATIONS 2001)**

In terms of the Asbestos Regulations GNR 155 of 2002, any person who intends to carry out asbestos work must be a Registered Asbestos Contractor, with the Department of Labour, before commencing with asbestos work. In terms of Asbestos Regulations "Registered Asbestos Contractor" means a mandatory or employer conducting demolition of asbestos work, who is registered with the Chief inspector of the Department of Labour

Notification of Intent and Contents of the Plan of work.

Notify all relevant authorities before starting on asbestos related work in writing including submission of Contents of the Plan of Work.

Method for handling and removing of Asbestos and Asbestos Containing Material During Demolition Work.

Provide for approval the method statement and remove existing Asbestos ceiling boards including cornices, cover and jointing strips in accordance with the approved method.

Respirators

Provide employees with respirators approved by the chief inspector for use when working with asbestos in a work place area not more than 100m² in size.

Carried to Collection

Section No. 2
Bill No. 1
ALTERATIONS

DEVELOPMENT BANK OF SOUTH AFRICA

R

Protective clothing

Suitable clothing overalls or similar full-body protective clothing with head covering and gumboots in a work place area not more than 100m² in size.

Arrange for the disposal or laundering of protective clothing a work place area not more than 100m² in size.

Ensure that protective clothing is removed from the premises only for laundering or disposal and then only if suitably packed in a sealed impermeable container, and that it is clearly labelled with a warning label as containing asbestos contaminated clothing in a work place area not more than 100m² in size.

Decontamination facilities and personal hygiene.

Set-up decontamination facilities, for a work place area not more than 100m² in size, outside the workplace for the exclusive use of employees exposed to asbestos. These facilities shall consist of a "clean" change-room, toilet/shower facilities and a "dirty" decontamination change-room with vacuum-cleaners for the preliminary de-dusting of protective clothing in a total work place area not more than 100m² in size.

Carried to Collection

R

Section No. 2
Bill No. 1
ALTERATIONS

DEVELOPMENT BANK OF SOUTH AFRICA

Workplace isolation and preparation

Isolate the workplace area not more than 100m² in size for the duration of the work by completely sealing off all openings to and fixtures in the workplace, such as doors, windows, ventilation ducts and lighting. Strong plastic sheeting, with all joints carefully sealed, which is taped securely in place, provides an effective form of isolation.

Post signs in and around a work place area not more than 100m² in size conspicuously, prohibiting people from and warning them against entering the workplace.

Vacuum-clean all removable items in a work place area not more than 100m² in size and equipment that are not attached to asbestos-containing material, remove them from the workplace, and only return them to the workplace after the work has been completed and the workplace has been decontaminated.

Vacuum-clean and then cover all non-removable items and equipment in a work place area not more than 100m² in size with plastic sheeting that is taped securely in place or by other suitable means.

Remove all air filters from air-conditioners and ventilation equipment, in a work place area not more than 100m² in size, and place them in impermeable bags or similarly effective containers that are sealable for disposal (the outside of all containers shall be cleaned before leaving the workplace).

Establish emergency and fire exits in a work place area not more than 100m² in size and ensure that employees are informed of emergency procedures, which procedures shall have priority over all other procedures.

Carried to Collection

Section No. 2
Bill No. 1
ALTERATIONS

DEVELOPMENT BANK OF SOUTH AFRICA

R

Disposal of waste.

The Registere Asbestos Contractor will be responsible to locate a suitable waste disposal site and will ensure that the asbestos waste is disposed of in a suitable manner in accordance with the Asbestos Regulations.

Collect asbestos section per section 100m² in size from where work is in progress and place in impermeable plastic bags or similarly effective containers. Before leaving the workplace all containers shall be cleaned on the outside and labelled, and, in the case of bags, the bag containing the waste shall be placed in another clean bag, sealed and labelled.

Place all plastic sheeting, tape, cleaning material, clothing and all other disposable items used in a work place area not more than 100m² in size into impermeable plastic bags or similarly effective containers and clean on the outside and label.

Dispose of the abestos waste, removed from ceilings in a work place area not more than 100m² in size, only on waste disposal sites specifically designated for this purpose in terms of the Environment Conservation Act, 1989 (Act 73 of 1989) and provide disposal certificates at completion.

The rate shall include for the arrangements made for the asbestos disposal which shall be agreed upon with the appropriate local authority as wells as transport of waste in a suitable waste containment vehicle from the site to the waste disposal site indicated by the Asbestos Contractor

Decontamination of the workplace.

Conduct frequent air sampling throughout the entire operation to ensure that the operation does not cause a hazard inside or outside in a work place area not more than 100m² in size and provide record keeping on a daily basis.

Carried to Collection

R

Section No. 2
Bill No. 1
ALTERATIONS

DEVELOPMENT BANK OF SOUTH AFRICA

All hazardous materials, e.g. Asbestos, etc. must be removed and disposed off site by a specialist firm as per government regulations and environmental laws.

2	Profiled or Asbestos roof sheeting	m2	105
3	Asbestos fascias and barge boards	m	48

ALTERATIONS

Breaking up and removing screeds, plaster, etc

4	30mm Thick screed	m2	45
5	Plaster on walls	m2	509

Taking out and removing brickwork, blockwork, etc.

6	Half brick walls in beamfilling	m2	3
---	---------------------------------	----	---

Taking down and removing roofs, floors, panelling, ceilings, partitions, etc.

7	Gypsum plasterboard or fibre cement ceilings including cornices, timber bandering, etc.	m2	403
---	---	----	-----

8	Gutters and down pipes from roofs to be demolished	m	172
---	--	---	-----

Take out and remove doors, windows, etc. including thresholds, sills, etc. and prepare opening to receive new doors, frames, windows, etc. (all elsewhere measured)

9	Timber single door not exceeding 2,5m2	No	23
---	--	----	----

10	Timber skirting	m	50
----	-----------------	---	----

Taking out and removing floor coverings

11	Take out and remove vinyl tile floor covering	m2	120
----	---	----	-----

MAKING GOOD OF FINISHES, ETC.

Carried to Collection

R

Section No. 2
 Bill No. 1
 ALTERATIONS

DEVELOPMENT BANK OF SOUTH AFRICA

	<u>Making good internal cement plaster</u>			
12	Chase out plaster cracks to form recess 25mm wide and 20mm deep and fill with 1:4 cement mortar, including floating up smooth to match existing.	m	28	
	<u>Making good external cement plaster</u>			
13	To walls in small areas	m2	42	
	<u>SERVICE EXISTING EQUIPMENT, REPAIRS, ETC.</u>			
	<u>Service existing steel windows</u>			
14	Overhaul, adjust and service to ensure proper operation existing steel window unit not exceeding 2.5m2	No	65	
15	Extra on servicing existing steel window sash for supplying and replacing new brass fittings.	No	65	
	<u>Service existing chalk boards</u>			
16	Overhaul, adjust and service to ensure proper operation existing writing boards approximately 2400mm wide x 1200mm high complete	No	6	
	<u>TEMPORARY STRUCTURES</u>			
	<u>Supply, install, commission and remove temporary Structure</u>			
17	Supply, install, commission and remove after a period of 8 months as directed by the Principal Agent mobile classrooms, 7 x 7m internally, fully insulated and ventilated. This amount may be paid pro-rata as may be directed by the Principal Agent.	No	9	
18	Supply, install, commission and remove after a period of 8 months as directed by the Principal Agent mobile toilets. This amount may be paid pro-rata as may be directed by the Principal Agent.	No	1	
	Carried to Collection			R
	Section No. 2 Bill No. 1 ALTERATIONS			
	DEVELOPMENT BANK OF SOUTH AFRICA			

Section No. 2

Bill No. 1

ALTERATIONS

COLLECTION

Total Brought Forward from Page No.

**Page
No**

Amount

51

52

53

54

55

56

57

58

59

60

61

Carried Forward to Summary of Section No. 2

R

Section No. 2

Bill No. 1

ALTERATIONS

DEVELOPMENT BANK OF SOUTH AFRICA

Mortar test cubes

Descriptions and tendered rates for mortar strength test cubes, as required by the Principal Agent, shall be deemed to cater for all the costs of providing cube moulds necessary for the purpose, making, storing and sending thereof to an approved laboratory for testing, paying all charges in connection therewith and for submitting test result reports to Principal Agent

It will be required from the Contractor to prepare mortar strength test cubes for each building at a frequency as decided upon by the Principal Agent

All mortar strength test cubes shall be labelled and the identity thereof (ie. date, mortar strength type, position where batch was taken from relative to the building and building identity) shall be properly recorded for future reference

Brickwork

Bricks shall be laid on a solid bed of mortar and all joints shall be grouted up solid

The brickwork shall be carried up in a uniform manner, no part being raised more than 1.2m above adjoining work

Sizes in descriptions

Where sizes in descriptions are given in brick units, "one brick" shall represent the length and "half brick" the width of a brick

Face bricks

Bricks shall be ordered timeously to obtain uniformity in size and colour

Pointing

Descriptions of recessed pointing to fair face brickwork and face brickwork shall be deemed to include square recessed, hollow recessed, weathered pointing, etc

Carried to Collection

R

Section No. 2
Bill No. 2
MASONRY

DEVELOPMENT BANK OF SOUTH AFRICA

Samples

Samples of all masonry building units, except for walls described as "load bearing" shall consist of a minimum of 6 units. Samples of building units to be used in walls described as "load bearing" shall consist of 30 units from every 30 000 units delivered to site

Prices

Prices for brickwork shall include for cutting , fitting and building around structural steel members

SAMPLES

Samples of all masonry building units, except those for walls described as "load bearing", shall consist of a minimum of 6 units. Samples of building units to be used in walls described as "load bearing" shall consist of 30 units from every 30 000 units delivered to site

BRICKWORK

SUPERSTRUCTURE

Brickwork of NFP bricks in class II mortar

1	110mm wall in isolated areas, including toothing bonding	m2	15	
---	--	----	----	--

SUNDRIES

Brick reinforcement

2	Brick reinforcement 75mm wide built into brick walls with sufficient laps at end joints, angles and intersections (measured net)	m	45	
---	--	---	----	--

Galvanised wire ties, hoop iron, etc.

3	30 x 1,6mm Galvanised hoop iron roof tie 1600mm girth with one end fixed to timber and other end fixed to brickwork	No	8	
---	---	----	---	--

FIBRE-CEMENT WINDOW SILLS

Carried to Collection

R

Section No. 2
Bill No. 2
MASONRY

DEVELOPMENT BANK OF SOUTH AFRICA

	<u>Fibre cement FC77 or equal and approved natural grey sills in single lengths bedded in class I mortar including metal fixing lugs etc</u>				
4	15 x 150mm Wide cills set flat and slightly projecting	m	16		
Carried to Collection					R
Section No. 2 Bill No. 2 MASONRY					
DEVELOPMENT BANK OF SOUTH AFRICA					

Section No. 2

Bill No. 2

MASONRY

COLLECTION

Total Brought Forward from Page No.

**Page
No**

Amount

63

64

65

66

Carried Forward to Summary of Section No. 2

R

Section No. 2

Bill No. 2

MASONRY

DEVELOPMENT BANK OF SOUTH AFRICA

	<u>Polysulphide sealant finished flush</u>				
2	Sealing around 50mm diameter pipes	No	4		
3	Sealing around 110mm diameter pipes	No	5		
Carried to Collection					R
Section No. 2					
Bill No. 3					
WATERPROOFING					
DEVELOPMENT BANK OF SOUTH AFRICA					

Section No. 2

Bill No. 3

WATERPROOFING

COLLECTION

Total Brought Forward from Page No.

**Page
No**

68

69

Amount

Carried Forward to Summary of Section No. 2

R

Section No. 2

Bill No. 3

WATERPROOFING

DEVELOPMENT BANK OF SOUTH AFRICA

Section No. 2

Bill No. 4

ROOF COVERINGS

COLLECTION

Total Brought Forward from Page No.

**Page
No**

71

72

Amount

Carried Forward to Summary of Section No. 2

R

Section No. 2

Bill No. 4

ROOF COVERINGS

DEVELOPMENT BANK OF SOUTH AFRICA

R

Descriptions of hardwood joinery shall be deemed to include pelleting of bolt holes

Decorative laminate finish

Laminate finish shall be glued under pressure. Edge strips shall be butt jointed at junctions with adjacent similar finish

Hardwoods

All hardwoods shall be specially selected, well seasoned, free from sapwood and kiln dried. Meranti shall be Red or Medium Brown Meranti, even in grain and colour, selected from "Standard and Better" quality from Malaysia

Sealing of all abutments

All cupboards, counter tops, shelves, etc. abutting walls, tiled surfaces, etc. to be sealed watertight with an approved silicon sealant along all joints

Tendered rates must make provision for this as no additional claims in this regard will afterwards be entertained

Carried to Collection

R

Section No. 2

Bill No. 5

CARPENTRY & JOINERY

DEVELOPMENT BANK OF SOUTH AFRICA

Descriptions

The term "planted on" shall mean the nailing of one timber member to another.

The term "screwed on" shall mean the countersunk screwing of one timber member to another.

The term "screwed on and pelleted" shall mean the screwing of one timber member to another with the heads of screws sunk and pelleted.

The term "plugged" shall mean the countersunk screwing of a timber member to and including plastic plugs in brickwork or concrete.

The term "plugged and pelleted" shall mean the screwing of a timber member to and including plastic plugs in brickwork or concrete with heads of screws sunk and pelleted.

The term "nailed" shall be deemed to be fixed with hardened steel nails or shot pins to brickwork or concrete

Descriptions of floors, ceilings, joinery, etc. shall be deemed to include for all square cutting.

Descriptions of items given in lineal metre shall be deemed to include for mitres, stopped ends, fitted intersections, etc.

Descriptions of rounded angles, rebates, grooves, chamfers, moulded edges, etc. shall be deemed to include for angles, ends, etc.

ROOFS, ETC

Plate nailed timber roof truss construction

a. Roof truss spacing must not exceed 1250 mm centres and must be constructed with pitch not less than 15°

b. Roof trusses to be designed and constructed with softwood structural timber to include for live loads, wind loads and to take rib iron roof covering purlins and fibre cement or gypsum plasterboard ceilings with brandering. Each roof truss shall have all its members accurately cut

Carried to Collection

Section No. 2

Bill No. 5

CARPENTRY & JOINERY

DEVELOPMENT BANK OF SOUTH AFRICA

R

and close butted together and rigidly fixed by CSIR approved patented galvanized metal spiked connectors, fixed on both sides of each intersection by an approved method, all in accordance with the manufacturer's instructions

c. Unless otherwise described all rafter feet are to extend 1800 mm beyond the length of the tie beam, with ends twice splay cut.

d. The tenderer's attention is drawn to the fact that the detail drawings included at the back of these Bills of Quantities are the required design of the roof structure. It will still be the contractors duty to see that the overall size and bearing points of the trusses meet with the architectural drawings and the completed wall structure. The manufacture and transportation of the roof trusses bracing etc. shall be in accordance with SABS 0243 and under control of a registered engineer. It shall be required from the manufacturer of the trusses to lodge a written guarantee that his construction has been constructed according to the plans and that he is in possession of a capability certificate issued by the Institute for Timer Construction and approved by the Representative/ Agent/ Engineer

e. If the contractor's supplier decided on an alternative design, the design manufacture and transportation of the roof trusses, bracing, etc. shall be in accordance with SABS 0243 and under the control of a registered Engineer. It shall be required from the manufacturer of the trusses to lodge a written guarantee that his construction has been designed by a qualified Structural Engineer and that he is in possession of a capability certificate issued by the Institute for Timer Construction and approved by the Representative/ Agent/Engineer. The manufacturers must supply a complete set of all drawings with the necessary structural and erection details on the drawings and must submit it to the representative/Agent/Engineer before the Contractor start with any work related to the roofstructure. After approval of the drawings by the Representative/ Agent/Engineer, the Contractor may order the material and continue with the work on the roof structure. An approved set of A1 drawings on drawing film must be handed to the Representative/Agent/Engineer to be included in his set of "as build" drawings after completion of the contract.

Carried to Collection

Section No. 2

Bill No. 5

CARPENTRY & JOINERY

DEVELOPMENT BANK OF SOUTH AFRICA

R

f. Erection must be carried out as described in "The Erection and Bracing of Timber Roof Trusses" published by the Truss Plate Association of South Africa Ltd. and the National Timber Research Institute, CSIR. Apply the alternative fastening methods in the above mentioned documents as follows: Use galvanized wire, bound twice at each connection to tie the purlins where the roof is covered with ceiling board. Use Hurricane clips at each connection where the roof is in the open.

g. Description of roof trusses shall be deemed to include for design, manufacture, supply, hoisting and fixing in position, trimming ends, notching, etc, and for any temporary bracing.

Rates for complete roof truss construction shall include bracings, purlins, splay cut ends, mitres, jointing, wrought and shaped ends, connections, bolts, cleats, gussets and timber connectors, hip- or valley sets and fixing in position.

Sundries

1	Two coats ABE PROVONITE on exposed timbers	m2	28		
---	--	----	----	--	--

EAVES, VERGES, ETC

Everite medium density plain nutec-cement

2	12 x 225mm Fascia with plastic H-profile joint strips, screwed to timber with 14 x 40mm brass screws	m	59		
---	--	---	----	--	--

3	12 x 225mm Barge boards with plastic H-profile joint strips, screwed to timber with 14 x 40mm brass screws	m	20		
---	--	---	----	--	--

SKIRTINGS & BUMPRAILS

Wrought meranti

4	20 x 70mm Skirting nailed with 19mm quarter round	m	50		
---	---	---	----	--	--

DOORS, ETC

Carried to Collection

R

Section No. 2

Bill No. 5

CARPENTRY & JOINERY

DEVELOPMENT BANK OF SOUTH AFRICA

	<u>Swartland Heavy duty solid flush doors with two concealed hardwood edge strips</u>				
5	40mm Thick hardboard heavy duty interior solid core flush door with two concealed edges, size 864 x 2032mm high	No	9		
6	40mm Thick hardboard heavy duty interior solid core flush door with two concealed edges, size 813 x 2032mm high.	No	14		
	<u>Swartland Gold Wrought meranti doors hung to steel frames</u>				
7	44mm Thick SD2 framed, ledged, braced and battened backply back door, size 813 x 2032mm high, sealed with a linseed oil based transit stabilizing sealer	No	1		
Carried to Collection					R
Section No. 2 Bill No. 5 CARPENTRY & JOINERY DEVELOPMENT BANK OF SOUTH AFRICA					

Section No. 2

Bill No. 5

CARPENTRY & JOINERY

COLLECTION

Total Brought Forward from Page No.

**Page
No**

Amount

74

75

76

77

78

79

Carried Forward to Summary of Section No. 2

R

Section No. 2

Bill No. 5

CARPENTRY & JOINERY

DEVELOPMENT BANK OF SOUTH AFRICA

BILL NO. 8

PREAMBLES

SUPPLEMENTARY PREAMBLES

Descriptions

Items described as "nailed" shall be deemed to be fixed with hardened steel nails or pins or shot pinned to brickwork or concrete

Items described as "plugged" shall be deemed to include screwing to fibre, plastic or metal plugs in brickwork or concrete at not exceeding 600 mm centres, and where described as "bolted" the bolts have been given elsewhere

Ceilings

Unless otherwise described ceilings shall be deemed to be horizontal

Carried to Collection

Section No. 2
Bill No. 6

CEILINGS, PARTITIONS AND ACCESS FLOORING

DEVELOPMENT BANK OF SOUTH AFRICA

R

Bulkheads

Bulkheads are defined as those portions of ceilings which are stepped down from the general ceiling level in a particular room or area and which generally occur along the perimeter. Their purpose is either to conceal services or to create architectural features

Bulkheads have only been described as such where they conform to the above definition and where the horizontal or vertical dimensions do not exceed 900mm. Where these dimensions are more than 900mm such portions of ceilings have been included in the appropriate general items of ceilings

Finishes to suspended ceilings

All finishes to be applied at the factory during the manufacturing process and to be delivered on site "pre-finished" as described. No applying of finishes on site will be allowed

Fixing of electrical light fittings, diffusers, panels, etc. to suspended ceilings

Electrical light fittings, diffusers, panels, etc. generally are "lay in" units of the same dimensions as the suspension grid described and allowance must be made accordingly for their support inclusive of any flexibility in setting out that may be required (ceiling panels have not been deducted and pricing is to take cognizance thereof)

NAILED UP CEILINGS

Sawn softwood

1	38 x 76mm Runners (Provisional)	m	16
2	38 x 114mm Ceiling joists (Provisional)	m	62
3	38 x 38mm Hangers (Provisional)	m	273

Carried to Collection

Section No. 2

Bill No. 6

CEILINGS, PARTITIONS AND ACCESS FLOORING

DEVELOPMENT BANK OF SOUTH AFRICA

R

	<u>9mm "Rhinoboard" plain ceiling boards with H- section metal cover strips over joints</u>				
4	Horizontal ceilings, including 38 x 50mm sawn softwood bandering at 450mm centres.	m2	991		
5	Extra over ceiling for opening for 680 x 696 mm trap door complete with trimmers, frame, cross branders, ceiling board, hinges, etc	m	12		
	<u>4mm Fibre cement ceiling boards with H-section</u>				
6	Horizontal ceilings, including 38 x 50mm sawn softwood bandering at 450mm centres	m2	12		
	<u>Wrought meranti</u>				
7	<u>32 x 69mm Rebated cornice nailed</u>	m	608		
	<u>CEILING INSULATION</u>				
	<u>Approved 80mm thick flexible non-combustible mineral wool insulation</u>				
8	"Isotherm" or similar approved 80mm Insulation laid loose on ceiling with closely butted joints and ends	m2	991		
Carried to Collection					
Section No. 2					
Bill No. 6					
CEILINGS, PARTITIONS AND ACCESS FLOORING					
DEVELOPMENT BANK OF SOUTH AFRICA					

R

Section No. 2

Bill No. 6

CEILINGS, PARTITIONS AND ACCESS FLOORING

COLLECTION

Total Brought Forward from Page No.

**Page
No**

Amount

81

82

83

Carried Forward to Summary of Section No. 2

R

Section No. 2

Bill No. 6

CEILINGS, PARTITIONS AND ACCESS FLOORING

DEVELOPMENT BANK OF SOUTH AFRICA

Sundries

POLISH, SEALERS, ETC

2	Two coats approved terpolymer floor sealer on vinyl flooring	m2	15
---	--	----	----

Carried to Collection

R

Section No. 2
Bill No. 7
FLOOR COVERINGS

DEVELOPMENT BANK OF SOUTH AFRICA

Section No. 2

Bill No. 7

FLOOR COVERINGS

COLLECTION

Total Brought Forward from Page No.

**Page
No**

85

86

Amount

Carried Forward to Summary of Section No. 2

R

Section No. 2

Bill No. 7

FLOOR COVERINGS

DEVELOPMENT BANK OF SOUTH AFRICA

DEVELOPMENT BANK OF SOUTH AFRICA

	<u>"Union"or similar approved by the Architect</u>				
1	Solid Art 390/313 four lever mortice lockset with satin chrome plated handles	No	23		
2	Master key	No	1		
	<u>PULL HANDLES</u>				
	<u>Chairman Industries</u>				
3	'Ref DL3' angled grab rail fitted to brickwork	No	2		
4	'Ref SR2' Stainless steel wall mounted rear grab rail around cistern	No	2		
	<u>DOOR CLOSERS</u>				
	<u>"Union" or other equal and approved</u>				
5	MAB609DV Door closer with bracket fixed to metal (Provisional).	No	2		
	<u>LETTERS, NAMEPLATES, ETC (PROVISIONAL)</u>				
	<u>5mm Clear perspex signs (Provisional)</u>				
6	30mm High with one to three 25mm high letters or numerals engraved to back, fixed to steel door frame with two thief-proof screws.	No	16		
	<u>"Solid"or similar approved by the Architect</u>				
7	Art 733/66/E/IF5/C91indicator plate with fire extinguisher symbol	No	8		
	<u>"Union"or similar approved by the Architect</u>				
8	AL5066E-00/2ASE10 Aluminium, anodised silver engraved sign size, 152 x 152 x 2mm engraved with Male Pictogram E10	No	2		
Carried to Collection				R	
Section No. 2 Bill No. 8 IRONMONGERY					
DEVELOPMENT BANK OF SOUTH AFRICA					

9	AL5066E-00/2ASE11 Aluminium, anodised silver engraved sign size, 152 x 152 x 2mm engraved with Female Pictogram E11	No	2		
10	AL5066E-00/2ASE14 Aluminium, anodised silver engraved sign size, 152 x 152 x 2mm engraved with Paraplegic Pictogram E14	No	2		
<u>BATHROOM FITTINGS, ETC</u>					
<u>"Franke" or similar approved by the Architect</u>					
11	Stainless steel mirror (code: CHRH 401) with high polish finish, size 300 x 400mm including four drillings for fixing to wall with mirror screws	No	4		
12	Surface mounted toilet roll holder (code: STRX 671) with satin finish and cylinder lock	No	16		
13	Surface mounted paper towel dispenser (code: STRX 600) with satin finish and cylinder lock.	No	4		
14	Surface mounted soap dispenser (code: STRX 618) with satin finish and cylinder lock.	No	4		
<u>SUNDRIES</u>					
<u>"Union" or similar approved by the Architect</u>					
15	AL8253AS Hat, coat and robe hook	No	4		
16	AL8730AS Aluminium door stop	No	23		
<u>"Halcast" or similar approved by the Architect</u>					
17	166-CP Halstead chrome plated 200mm cabin hook	No	2		
<u>"Cecil Nurse" or similar approved by the Architect</u>					
18	Mild steel key box for 100 keys, with epoxy powder coating	No	1		
Carried to Collection				R	
Section No. 2 Bill No. 8 IRONMONGERY					
DEVELOPMENT BANK OF SOUTH AFRICA					

	<u>Buchels medicine safes (supplier : Buildware tel. 031 332 5764)</u>				
19	No. 45 Code 00730800 wall unit 380 x 360 x 610mm high	No	1		
	<u>PINNING BOARDS, WRITING BOARDS, PROJECTION SCREENS, ETC</u>				
	<u>"Vitrex" Series 2109 or similar approved by the Architect Wall mounted pinning board</u>				
20	Code 2109 pinning board 4800 x 1200mm high	No	6		
21	Code 2109 pinning board 1200 x 1200mm high	No	2		
	<u>"Vitrex" Series 2109 or similar approved by the Architect Wall mounted green writing board 4800 x 1200 high with chalk rail and two folding leaves</u>				
22	Code 2109 writing board 4800 x 1200mm high with chalk rail plugged	No	1		
	<u>"Vitrex" or similar approved by the Architect Wall mounted magnetic writing board 1500 x 1200 high</u>				
23	Code 2109 magnetic writing board 1200 x 1200mm high	No	1		
Carried to Collection					R
Section No. 2 Bill No. 8 IRONMONGERY					
DEVELOPMENT BANK OF SOUTH AFRICA					

Section No. 2

Bill No. 8

IRONMONGERY

COLLECTION

Total Brought Forward from Page No.

**Page
No**

Amount

88

89

90

91

Carried Forward to Summary of Section No. 2

R

Section No. 2

Bill No. 8

IRONMONGERY

DEVELOPMENT BANK OF SOUTH AFRICA

R

Metalwork described as "holed for bolt(s)" shall be deemed to exclude the bolts unless otherwise described

Welded joints and intersections

Prices of continuous rails shall include for welded joints in the length and prices of intersections shall include all cutting, mitring, scribing, shaping, etc

Bends, knees, ramps and the like to continuous rails shall be forged and rounded to approved radii

Prices for balustrades, burglar guards and the like shall include for framed and welded joints at intersections

Screws and bolts

Screws and bolts shall be of corresponding metal and colour and heads of screws shall be countersunk. Self-tapping screws shall, unless described otherwise, be used for screwing items to adjoining metalwork. Stainless steel screws shall be used for fixing aluminium

Items fixed to adjoining metalwork with rivets, self-tapping screws, machine screws, etc shall include all necessary drillings

Where bolting is specified, projecting shank ends of bolts shall be cut off flush and left smooth

Door frames

Unless otherwise described, the following shall be applicable on all door frames:

- Frames shall be double rebated suitable for 40mm thick doors
- One jamb of all frames for single doors shall be factory prepared for striking plate of mortice lock
- All frames shall be factory fitted with three washered butt hinges for each door
- All frames shall be treated with one coat factory applied metal primer complying with SANS Specification 909

Carried to Collection

Section No. 2
Bill No. 9
METALWORK

DEVELOPMENT BANK OF SOUTH AFRICA

R

Striking plates for door frames

Striking plates to be of chromium-plated type, unless otherwise described

Burglar bars to steel windows

All opening sections shall be filled with type B20 burglar bars, unless otherwise described

Furniture to steel windows

All steel type windows shall be fitted with chromium-plated furniture

Sealing of all abutments

All windows, etc. abutting face brick walls, etc. to be sealed watertight with an approved silicon sealant along all joints and prices to allow therefore

GALVANIZED STEEL GATES, SCREENS, ETC

Welded gates, screens, etc.

- 1 Galvanised single mild steel gates size 900 x 2100mm high of 40 x 60 x 3mm hollow section frame and two 40 x 6mm flat section middle rails holed for five 19mm diameter solid metal rods to pass through and welded to gate frame with one upright double throw security mortice deadlock in steel plate housing with cover plate etc, gate fixed to 40 x 60 x 3mm hollow section frame fitted with three pin hinges, bottoms welded to frame and tops welded to gate, frame holed for and fitted with eight 90mm long rawl bolts.

No

4

Carried to Collection

R

Section No. 2
Bill No. 9
METALWORK

DEVELOPMENT BANK OF SOUTH AFRICA

Section No. 2

Bill No. 9

METALWORK

COLLECTION

Total Brought Forward from Page No.

**Page
No**

Amount

93

94

95

Carried Forward to Summary of Section No. 2

R

Section No. 2

Bill No. 9

METALWORK

DEVELOPMENT BANK OF SOUTH AFRICA

R

Granolithic

Granolithic shall be cured for at least seven days after laying

Coloured granolithic shall be carried out in two coats in one operation and shall be tinted to the required colour with approved colouring pigment mixed into the finishing coat. Under no circumstances is the pigment to be sprinkled on and trowelled in after the granolithic is laid

Granolithic shall be divided into panels not exceeding 6m² with V-joints and deep trowel cuts

Granolithic to stairs shall include non-slip reedings to treads

Skirtings

Skirtings shall not exceed 25mm thick and shall have a fair edge with arris or rounded external angle at top edge or V-joint to finish flush with plaster and coved or square junction with floor finish

Plaster

All plaster, other than skim plaster, shall not be less than 10mm and not more than 20mm thick

General

Rates for plastering described as being on walls shall include concrete columns, beams and lintels flush with the face of the wall

Textured finishes

All textured finishes are to be applied to the satisfaction of the Principal Agent and executed by an approved firm of specialists, all strictly in accordance with the materials supplied and methods employed by the manufacturer

Carried to Collection

R

Section No. 2
Bill No. 10
PLASTERING

DEVELOPMENT BANK OF SOUTH AFRICA

Preparatory work for textured finishes

Textured finishes to be applied to surfaces as described.
Rates tendered are to include for all necessary priming,
preparatory work, etc

All surfaces are to be inspected and approved by the
Principal Agent prior any work is commenced

SCREEDS

Screeds on concrete in class 2, strength category C

1	30mm Thick on floors and landings	m2	45		
---	-----------------------------------	----	----	--	--

INTERNAL PLASTER

One coat (1:5) cement plaster on brickwork

2	On walls in patches	m2	45		
---	---------------------	----	----	--	--

3	On walls	m2	509		
---	----------	----	-----	--	--

4	On narrow widths	m2	22		
---	------------------	----	----	--	--

EXTERNAL PLASTER

Cement plaster on brickwork

5	On walls	m2	250		
---	----------	----	-----	--	--

6	On narrow widths	m2	42		
---	------------------	----	----	--	--

Carried to Collection

R

Section No. 2
Bill No. 10
PLASTERING

DEVELOPMENT BANK OF SOUTH AFRICA

Section No. 2

Bill No. 10

PLASTERING

COLLECTION

Total Brought Forward from Page No.

**Page
No**

Amount

97

98

99

Carried Forward to Summary of Section No. 2

R

Section No. 2

Bill No. 10

PLASTERING

DEVELOPMENT BANK OF SOUTH AFRICA

PREAMBLES

For preambles see "Construction Specifications - General Specification (PW371-A)" and "Construction Specifications - Particular Specification (PW371-B)"

SUPPLEMENTARY PREAMBLES

Items, materials or methods to be used specified by trade names or catalogue numbers are only an indication of the quality required. Items, materials or methods of similar quality may be used with prior approval from the architect

Descriptions

Unless described as "fixed with adhesive to plaster (plaster elsewhere)" descriptions of tiling on brick or concrete walls, columns, etc shall be deemed to include 1:4 cement plaster backing and descriptions of tiling on concrete floors etc shall be deemed to include 1:3 plaster bedding

Prices

Prices are to include for all cutting and waste, cleaning off upon completion and protection from damages. Areas are measured net to face of bare brickwork and concrete. Any additional area caused by the thickness of tiling and screed are to be allowed for in prices

Carried to Collection

Section No. 2
Bill No. 11
TILING

DEVELOPMENT BANK OF SOUTH AFRICA

Quantity

Rate

Amount

R

General

Tiles, mosaics, etc shall be even in shape and size, free from cracks, twists or blemishes and uniform in colour

Surfaces shall be clean and free from oil and thoroughly wetted directly before any tiling is commenced. All surfaces shall be prepared as per manufacturer's instructions to form a proper key

Where tiles are fixed to plaster or screeds with an adhesive, the adhesive shall be as recommended by the manufacturer of the tiles. Joints shall be straight, continuous and flush pointed with an approved grouting compound

WALL TILING

200 x 200 x 6.5mm Thick "Johnson Matisse" MA 6 CoolGrey glazed ceramic tiles pointed with anti-bacterial grout (plaster elsewhere)

1	On walls in isolated panels, splashbacks, etc	m2	52
---	---	----	----

FLOOR TILING

300 x 300 x 10mm Slip Free unglazed porcelain floor tiles on 10mm bedding on concrete and flush pointed with tinted waterproof jointing compound (plaster elsewhere)

2	On floors and landings	m2	32
---	------------------------	----	----

Carried to Collection

R

Section No. 2
Bill No. 11
TILING

DEVELOPMENT BANK OF SOUTH AFRICA

Section No. 2

Bill No. 11

TILING

COLLECTION

Total Brought Forward from Page No.

**Page
No**

101

102

Amount

Carried Forward to Summary of Section No. 2

Section No. 2

Bill No. 11

TILING

DEVELOPMENT BANK OF SOUTH AFRICA

R

R

Prices

Prices must include for arranging joints at convenient points, embedding in concrete or for rough cutting around brickwork as the work proceeds

No distinction has been made between pipes chased in walls, fixed in ceilings, roofs, floors, columns, slabs, etc or for different finishes to these elements and has been dedcribed as "pipes".

Prices shall therefore include for all holderbats, brackets, clips, bands, etc and building in or chasing of same, holes through brickwork, concrete, etc and for making good facings, plaster, granolithic and other in- situ finishes as necessary

Prices to fixing of sanitary fittings etc shall include for setting up and fixing in position as described, joints to soil, waste and supply pipes as the case may be, making good finishes around and for protecting fittings from injury during subsequent building operations

Concrete pipes

Pipes shall be jointed with ogee joints with rubber collars or socket and spigot joints with rubber rings

uPVC pipes and fittings

Sewer and drainage pipes and fittings shall be jointed and sealed with butyl rubber rings Soil, waste and vent pipes and fittings shall be solvent weld jointed

uPVC pressure pipes and fittings

Pipes for water supply shall be of the class stated Pipes of 40mm diameter and smaller shall be plain ended with solvent welded uPVC loose sockets and fittings Pipes of 50mm diameter and greater shall have sockets and spigots with push-in type integral rubber ring joints. Bends shall be uPVC and all other fittings shall be cast iron, all with similar push-in type joints

Carried to Collection

R

Section No. 2

Bill No. 12

PLUMBING AND DRAINAGE

DEVELOPMENT BANK OF SOUTH AFRICA

Reducing fittings

Where fittings have reducing ends or branches they are described as "reducing". In the case of pipes with diameters not exceeding 60mm only the largest end or branch size is given. Should the contractor wish to use other fittings and bushes or reducers he may do so on the understanding that no claim in this regard will be entertained. In the case of pipes with diameters exceeding 60mm all sizes are given and no claim for extra bushes, reducers, etc will be entertained

Copper pipes

Pipes shall be hard drawn and half-hard pipes of the class stated. Class 0 (thin walled hard drawn) pipes shall not be bent. Class 1 (thin walled half-hard), class 2 (half-hard) and class 3 (heavy walled half-hard) pipes shall only be bent with benders with inner and outer formers. Fittings to copper waste, vent and anti-syphon pipes, capillary solder fittings and compression fittings shall be "Cobra Watertech" type. Capillary solder fittings shall comply with ISO 2016. Only compression fittings shall be used in walls or in ground

Exposed concrete surfaces

Exposed surfaces of concrete stormwater channels, cover slabs, inspection eye marker slabs, gulley tops, cleaning eye tops, catchpits, inspection chambers, etc shall be finished smooth with plaster

Excavations

No claim for rock excavation will be entertained unless the contractor has timeously notified the quantity surveyor thereof prior to backfilling

"Soft rock" and "hard rock" shall be as defined in "Earthworks"

Carried to Collection

R

Section No. 2

Bill No. 12

PLUMBING AND DRAINAGE

DEVELOPMENT BANK OF SOUTH AFRICA

Laying, backfilling, bedding, etc of pipes

Laying, backfilling, bedding, etc of pipes Pipes shall be laid and bedded and trenches shall be carefully backfilled in accordance with manufacturers' instructions

Where no manufacturers' instructions exist pipes shall be laid in accordance with clauses 5.1 and 5.2 of each of the following: SABS 1200L : Medium-pressure pipelines LD : Sewers LE : Stormwater drainage Pipe trenches etc shall be backfilled in accordance with clauses 3, 5.5, 5.6, 5.7 and 7 of SABS 1200 DB : Earthworks (Pipe trenches) Pipes shall be bedded in accordance with clauses 3.1 to 3.4.1, 5.1 to 5.3 and 7 of SABS 1200 LB : Bedding (Pipes). Unless otherwise described bedding of rigid pipes shall be class B bedding

Flush pans

Flush pans shall have straight or side outlets and "P" or "S" traps as necessary

Stainless steel basins, sinks, wash troughs, urinals, etc

Units shall have standard aprons on all exposed edges and tiling keys against walls where applicable

Waste unions

Descriptions of waste unions shall be deemed to include rubber or vulcanite plugs and chains fixed to fittings

Testing

Descriptions for the testing of plumbing and drainage installations shall be deemed to cater for all testing apparatus, labour, etc. and shall be done strictly as directed by and in accordance to the Principal Agent's instructions, including for re-testing after taking out and making good all defective work to his entire satisfaction

TESTING

Carried to Collection

Section No. 2

Bill No. 12

PLUMBING AND DRAINAGE

DEVELOPMENT BANK OF SOUTH AFRICA

R

<u>Water reticulation</u>					
1	Service internal water reticulation to all areas checking for		Item		
2	Service external water reticulation to all areas checking fo		Item		
3	Service all valves and taps replacing washers as necessary		Item		
<u>Sewer reticulation</u>					
4	Service internal sewer reticulation and associated waste as necessary		Item		
5	Inspect existing toilets and cisterns and ensure they are cc	No	38		
6	Remove damaged toilet seats and flap and replace with cc	No	16		
7	Inspect existing wash hand basins, wastes and taps and en providing suitable basin plugs where required.	No	23		
<u>RAINWATER DISPOSAL</u>					
<u>0,6mm Seamless aluminium with ColourTech G4 marble white finish.</u>					
8	125 x 85mm Eaves gutters	m	129		
9	Extra over eaves gutter for outlet for 75 x 100mm rainwater pipe.	No	8		
10	Extra for stopped end	No	8		
Carried to Collection				R	
Section No. 2 Bill No. 12 PLUMBING AND DRAINAGE					
DEVELOPMENT BANK OF SOUTH AFRICA					

11	75 x 100mm Fluted rainwater pipes in continuous lengths	m	44		
12	Extra over rainwater pipe for bend	No	8		
13	Extra over rainwater pipe for shoe	No	8		
14	Extra over 75 x 100mm rainwater pipe for eaves or plinth offset 600mm projection.	No	8		
<u>RAINWATER STORAGE</u>					
<u>"RotoTanks" or similar approved polyethylene storage tank</u>					
15	5000 Litre storage tank on 2100 x 2100 x 150 mm concrete platform, including tap. Tank secured tight to wall via bent flat bar. Rainwater storage detail: L0826-00-D-01A16-00	No	2		
<u>SANITARY PLUMBING</u>					
<u>"Franke"</u>					
Stainless steel for economy basins, domestic sinks, worktops and wash troughs shall be type 430 (17/0).					
Stainless steel for urinals, basins, quality sinks, wash troughs, institutional equipment, etc shall be type 304 (18/8).					
Stainless steel for laboratory sinks, photographic equipment, etc shall be type 316 (18/8).					
<u>"Vaal"</u>					
16	Vaal laboratory sink (code 2345) with acid resistant waste, plug and chain (code 8790Z0) including brackets fitted in laboratory counter.	No	1		
Carried to Collection				R	
Section No. 2 Bill No. 12 PLUMBING AND DRAINAGE					
DEVELOPMENT BANK OF SOUTH AFRICA					

17	415 x 275 x 315mm White vitreous china wall mounted urinal (code: 705326) including dominical grating (code: 8787Z0) and chromium plated top inlet spreader (code: 8543Z0) fixed on and including two hanger brackets (code:8127Z0) and urinal division (code:7052).	No	8		
18	'Aquasave' low level wc suite (code: 750151) comprising washdown pan with 9 litre cistern, complete with matching flushpipe, valve fittings and including DPE 'A1 de lux' single flap seat.	No	9		
19	550 X 400mm "Springbok" ceramic fireclay heavy duty basin (code: 7031), with two tapholes, fixed to wall on and including two semi concealed cast iron brackets (code: 8118Z0)	No	9		
20	'Protea' low level floor mounted paraplegic wc suite comprising washdown pan with matching 9 litre cistern, complete with flushpipe, lid, fitments, purpose made CP flush-lever and DPE 'A1 de lux' single flap seat.	No	2		
<u>WASTE UNIONS ETC</u>					
<u>"Cobra Watertech"</u>					
<u>SANITARY FITTINGS</u>					
21	40mm Basin waste union.	No	29		
<u>TRAPS ETC</u>					
<u>"Cobra Watertech" or other equal and approved</u>					
22	40mm 345 CP bottle trap.	No	8		
<u>Brass:</u>					
23	15mm Stopcock	No	4		
Carried to Collection				R	
Section No. 2					
Bill No. 12					
PLUMBING AND DRAINAGE					
DEVELOPMENT BANK OF SOUTH AFRICA					

24	20mm Fullway gate valve	No	4		
	<u>"Cobra" Watertech</u>				
25	15mm 232-10CP angle regulating valve	No	56		
26	15mm Chrome plated pillar tap	No	22		
27	15mm Chrome plated pillar tap with elbow action lever	No	4		
28	15mm FJ6.000CP Flushmaster Junior urinal flushvalve exposed type, with integral ballostop valve and wallplate complete	No	8		
29	15mm "Broen" chrome plated laboratory sink mixer with air-rated swivel spout and concealed connections	No	1		
30	15mm "Star" chrome plated sink mixer with air-rated swivel spout and concealed connections	No	2		
	<u>WASTES AND VENTS</u>				
	<u>uPVC soil and vent pipes</u>				
31	40mm Pipe fixed in walls, ceilings, roofs, floors, etc or laid in filling	m	65		
	<u>Extra over 40mm uPVC pipe for</u>				
32	Bend	No	12		
33	Access bend	No	6		
34	Bend with cleaning eye	No	9		
35	Junction with cleaning eye	No	4		
36	Access junction	No	2		
	<u>Sundries</u>				
37	Testing waste pipe system		Item		
Carried to Collection				R	
Section No. 2					
Bill No. 12					
PLUMBING AND DRAINAGE					
DEVELOPMENT BANK OF SOUTH AFRICA					

WATER SUPPLY

Class O thin wall hard drawn copper pipes and fittings with capillary soldered type connections

38	15mm Pipes	m	60		
39	22mm Pipes	m	40		
<u>Extra over class O copper pipes for soldered capillary fittings</u>					
40	15mm Fittings	No	30		
41	22mm Fittings	No	20		

ELECTRIC WATER HEATERS

"ZIP"

42	5 litre 'Franke Zip Hydroboil' water boiler with white polyester powder coated finish screwed to and including plugs in plastered wall with connection to 15mm copper pipe including necessary connector. (Electrical connection elsewhere measured)	No	1		
----	--	----	---	--	--

TESTING

43	Testing water pipe system		Item		
----	---------------------------	--	------	--	--

FIRE APPLIANCES ETC

Tempest Fire CIMA

44	4,5 kg Fire extinguisher size 181mm diameter x 416mm high (total mass 8kg) including backboard, plugged and screwed	No	12		
45	Everyway hose reel complete with 30m plastic hose, chromium plated stopcock, shut-off nozzle and wall bracket	No	6		

Carried to Collection

R

Section No. 2

Bill No. 12

PLUMBING AND DRAINAGE

DEVELOPMENT BANK OF SOUTH AFRICA

Section No. 2

Bill No. 12

PLUMBING AND DRAINAGE

COLLECTION

Total Brought Forward from Page No.

**Page
No**

Amount

104

105

106

107

108

109

110

111

112

Carried Forward to Summary of Section No. 2

R

Section No. 2

Bill No. 12

PLUMBING AND DRAINAGE

DEVELOPMENT BANK OF SOUTH AFRICA

R

PREPARATORY WORK TO EXISTING SURFACES

Previously painted plastered surfaces

All existing painted surfaces must be sanded and thoroughly washed down and allowed to dry completely before any paint is applied. Blistered or peeling paint shall be completely removed and cracks shall be opened, filled with a suitable filler and finished smooth

Previously painted metal surfaces

Surfaces shall be thoroughly rubbed and cleaned down. Blistered or peeling paint shall be completely removed down to bare metal

Previously painted wood surfaces

Surfaces shall be thoroughly cleaned down. Blistered or peeling paint shall be completely removed and cracks and crevices shall be primed, filled with suitable filler and finished smooth

PAINT ON PLASTER, ETC

Wire brush, wash down with "Polycell Sugar Soap" or weak spirits of salts, rinse, repair plastered surface and apply one coat "Plascon Plaster Primer" and two coats "Plascon Micatex" (Provisional)

1	On existing internal floated plaster walls	m2	4,052
2	On plastered ceilings	m2	22
3	On external plastered walls	m2	1,540

ON METAL

Carried to Collection

R

Section No. 2
Bill No. 14
PAINTWORK

DEVELOPMENT BANK OF SOUTH AFRICA

-117-

12	On pipework not exceeding 50mm diameter	m	76
	<u>One coat "Galvogrip metal primer", One Universal undercoat and Two coats "Plascon Enamel"</u>		
13	On door frames	m2	231
	<u>ON METAL ROOFS</u>		
	<u>Clean down and prime exposed roof with undercoat and colour Red Rock.</u>		
14	On roofs	m2	2,673
	<u>WOOD SURFACES WITH</u>		
	<u>One coat primer, one undercoat and one finishing coat of</u>		
15	On doors	m2	367
	<u>Three coats "Swartland Maxicare" timber sealant</u>		
16	On doors	m2	203
	<u>Surface to be dry, sound and clean and apply one coat "Plascon Woodcare Pre-treatment" and two coats "Plascon Woodcare Interior Water Based Wood Varnish"</u>		
17	Skirtings, cornices, rails, etc not exceeding 300 mm girth	m	922
18	Window sills	m	246

PAINTWORK, ETC TO NEW WORK

ON FLOATED PLASTER SURFACES WITH

Carried to Collection

Section No. 2
Bill No. 14
PAINTWORK

DEVELOPMENT BANK OF SOUTH AFRICA

R

19	<p>One coat "Plascon Plaster Primer" and two coats "Plascon Velvagio Satin"</p> <p>On internal walls</p> <p>m</p>			
	<p>Carried to Collection</p> <p>Section No. 2 Bill No. 14 PAINTWORK</p> <p>DEVELOPMENT BANK OF SOUTH AFRICA</p>		R	

Section No. 2

Bill No. 14

PAINTWORK

COLLECTION

Total Brought Forward from Page No.

**Page
No**

Amount

115

116

117

118

119

Carried Forward to Summary of Section No. 2

R

Section No. 2

Bill No. 14

PAINTWORK

DEVELOPMENT BANK OF SOUTH AFRICA

Bill No	SECTION SUMMARY - BUILDINGS	Page No	Amount
1	ALTERATIONS	62	
2	MASONRY	67	
3	WATERPROOFING	70	
4	ROOF COVERINGS	73	
5	CARPENTRY & JOINERY	80	
6	CEILINGS, PARTITIONS AND ACCESS FLOORING	84	
7	FLOOR COVERINGS	87	
8	IRONMONGERY	92	
9	METALWORK	96	
10	PLASTERING	100	
11	TILING	103	
12	PLUMBING AND DRAINAGE	113	
13	GLAZING	114	
14	PAINTWORK	120	
Carried to Final Summary			R
Section No. 2			
DEVELOPMENT BANK OF SOUTH AFRICA			

BILL NO. 1

PREAMBLES

For preambles see "Construction Specifications - General Specification (PW371-A)" and "Construction Specifications - Particular Specification (PW371-B)"

Specification and drawings

Tenderers are referred to the Electrical Specification and drawings annexed to these bills of quantities for full descriptions of the project specification, materials to be used, etc

Distribution boards etc

Rates for distribution boards etc are to include for busbars, jumpers, neutral bars, internal wiring and connections, circuit identification markers, control gear labels, circuit legend cards and working drawings

Switches, socket outlets, etc

Rates for switches, socket outlets, etc are to include for screwing to outlet boxes, connecting up and cover plates

Light fittings

Rates for light fittings are to include for hanging, fixing and connecting and for lamp holders and fluorescent tubes and lamps of the type and wattage described

Carried to Collection

Section No. 3

Bill No. 1

ELECTRICAL PRELIMINARY and GENERAL

DEVELOPMENT BANK OF SOUTH AFRICA

R

Certificates of Compliance

Contractor to note that Certificates of Compliance must be issued for all separate buildings, reticulation, etc. as directed by and to the satisfaction of the Principal Agent

PRELIMINARY AND GENERAL

In accordance with the Conditions of Contract; Provide for all expenses, obligations and general items pertaining to such conditions and all items not specifically specified or mentioned to enable the works to be completed in a satisfactory manner.

1 Fixed Portion

Item

2 Portion variable with Contract Price

Item

This is a Fixed Price - no escalation Contract.
Due allowance must be made for any possible
Material and Labor escalations and cost
increases

3 Portion variable with Contract Time

Item

Carried to Collection

R

Section No. 3

Bill No. 1

ELECTRICAL PRELIMINARY and GENERAL

DEVELOPMENT BANK OF SOUTH AFRICA

CONDITIONS TO CONSIDER IN PRICING

The rates shall include for the supply and installation of all items - except where indicated different - VAT Excl. -

Actual quantities and lengths shall be verified on site before any order is placed.

The alterations will be done within a fully functional school, and all work shall be executed with the least amount of disruptions to the classs, access, dust, noise, etc.

Additional General items
to be provided in terms of the contract and specifications.

4 Shop drawings, Submissions & Approvals

Item

5 Submission of samples

Item

Project Implementation - Start - Detailed CoC Investigation of each Block

The Contactor shall investigate each block and produce a comprehensive, detailed report indication the defects found and the action(s) required to achieve compliance with the Wiring Code, SANS 10142 Part 1, to be able to issue a CoC

6 Block 1 to 18

No

18

Carried to Collection

R

Section No. 3

Bill No. 1

ELECTRICAL PRELIMINARY and GENERAL

DEVELOPMENT BANK OF SOUTH AFRICA

Project Completion - Close out - ISSUE the following CoC

The Contactor certify compliance with the Wiring Code, SANS 10142 Part 1, and issue a CoC

7	Block 1 - 18	No	18
8	Allow for documentation regarding all inspections, testing, commissioning and handing over the complete installation, and the actual (original) Certificates of Compliance.	Item	
9	Guarantee and Maintenance of the Electrical installation for full 12 months.	Item	

Carried to Collection

R

Section No. 3
Bill No. 1

ELECTRICAL PRELIMINARY and GENERAL

DEVELOPMENT BANK OF SOUTH AFRICA

Section No. 3

Bill No. 1

ELECTRICAL PRELIMINARY and GENERAL

COLLECTION

Total Brought Forward from Page No.

**Page
No**

Amount

122

123

124

125

Carried Forward to Summary of Section No. 3

R

Section No. 3

Bill No. 1

ELECTRICAL PRELIMINARY and GENERAL

DEVELOPMENT BANK OF SOUTH AFRICA

4	Cable: 10mm ² x 3-Core Cu (Provisional) - Install	m			
5	Cable: 16mm ² x 3-Core Cu (Provisional) - Supply	m			
6	Cable: 16mm ² x 3-Core Cu (Provisional) - Install	m			
7	Cable: 25mm ² x 3-Core Cu (Provisional) - Supply	m			
8	Cable: 25mm ² x 3-Core Cu (Provisional) - Install	m			
9	Cable: 35mm ² x 4-Core Cu (Provisional) - Supply	m			
10	Cable: 35mm ² x 4-Core Cu (Provisional) - Install	m			
11	Cable: 10mm ² x 4-Core Cu (Provisional)+ 16mm ² BCEW - Supply	m			
12	Cable: 10mm ² x 4-Core Cu (Provisional)+ 16mm ² BCEW - Install	m			
13	Cable: 25mm ² x 4-Core Cu (Provisional) + 16mm ² BCEW - Supply	m			
14	Cable: 25mm ² x 4-Core Cu (Provisional) + 16mm ² BCEW - Install	m			
15	Cable: 35mm ² x 4-Core Cu (Provisional) + 25mm ² BCEW - Supply	m			
Carried to Collection				R	
Section No. 3					
Bill No. 2					
ELECTRICAL CABLING and EXCAVATIONS					
DEVELOPMENT BANK OF SOUTH AFRICA					

16	Cable: 35mm ² x 4-Core Cu (Provisional) + 25mm ² BCEW - Install	m			
	<u>CABLE TERMINATIONS</u>				
17	Cable: 6mm ² x 4-Core Cu (Provisional) - Supply	No			
18	Cable: 6mm ² x 4-Core Cu (Provisional) - Install	No			
19	Cable: 10mm ² x 3-Core Cu (Provisional) - Supply	No			
20	Cable: 10mm ² x 3-Core Cu (Provisional) - Install	No			
21	Cable: 16mm ² x 3-Core Cu (Provisional) - Supply	No			
22	Cable: 16mm ² x 3-Core Cu (Provisional) - Install	No			
23	Cable: 25mm ² x 3-Core Cu (Provisional) - Supply	No			
24	Cable: 25mm ² x 3-Core Cu (Provisional) - Install	No			
25	Cable: 35mm ² x 4-Core Cu (Provisional) - Supply	No			
26	Cable: 35mm ² x 4-Core Cu (Provisional) - Install	No			
27	Cable: 10mm ² x 4-Core Cu (Provisional)+ 16mm ² BCEW - Supply	No			
Carried to Collection				R	
Section No. 3 Bill No. 2 ELECTRICAL CABLING and EXCAVATIONS					
DEVELOPMENT BANK OF SOUTH AFRICA					

28	Cable: 10mm ² x 4-Core Cu (Provisional)+ 16mm ² BCEW - Install	No			
29	Cable: 25mm ² x 4-Core Cu (Provisional) + 16mm ² BCEW - Supply	No			
30	Cable: 25mm ² x 4-Core Cu (Provisional) + 16mm ² BCEW - Install	No			
31	Cable: 35mm ² x 4-Core Cu (Provisional) + 25mm ² BCEW - Supply	No			
32	Cable: 35mm ² x 4-Core Cu (Provisional) + 25mm ² BCEW - Install	No			
<u>CABLE TRENCHING</u>					
<u>800mm deep x 300mm wide cable trench</u>					
<u>NOTE: The unit of measure for the excavation of a cable trench is linear meter (not cubic meter) and no payment shall be made for excessively wide or deep excavations</u>					
33	Normal / Pickable Soil	m			
34	Trough / Under Paving	m			
35	Imported soil	m ³			
36	Bedding	m ³			
Carried to Collection				R	
Section No. 3 Bill No. 2 ELECTRICAL CABLING and EXCAVATIONS					
DEVELOPMENT BANK OF SOUTH AFRICA					

37	Blanketing	m3			
38	Backfilling	m			
39	Removal of spoil	m3			
40	Reinstate paving / concrete / asphalt (tar)	m			
41	Soft Rock (requires Mechanical Breaker)	m			
42	Hard Rock (requires Blasting)	m			
<u>SLEEVES</u>					
<u>Galvanized steel pipe for cable protection ("kick pipes") complete with and galvanized steel saddles at 1m intervals mounted to the structure with M8 "Rawl" Bolts</u>					
43	50mm Ø galvanized steel pipe - Supply	m			
44	50mm Ø galvanized steel pipe - Install	m			
<u>DANGER TAPE</u>					
45	"Caution – Electric Cable Below" tape 150mm wide, ≥100µm thick - Supply	m			
46	"Caution – Electric Cable Below" tape 150mm wide, ≥100µm thick - Install	m			
Carried to Collection					R
Section No. 3 Bill No. 2 ELECTRICAL CABLING and EXCAVATIONS					
DEVELOPMENT BANK OF SOUTH AFRICA					

POLE EXCAVATIONS

NOTE: The unit of measure for the excavation is "per pole" (not cubic meters) no payment shall be made for excisive excavatiuons

800mm deep hole for post top pole installation

47	Normal	No			
48	Backfilling	No			
<u>General purpose (GP) wire,</u> <u>All colours: Red / black / blue / white / yellow & green. Prc</u> <u>Wiring is included in the eqaupment rates. Only for use</u> <u>the Engineer.</u>					
49	2.5mm ² General purpose (GP) wire - Supply	m	100		
50	2.5mm ² General purpose (GP) wire - Install	m	100		
51	4mm ² General purpose (GP) wire - Supply	m	100		
52	4mm ² General purpose (GP) wire - Install	m	100		
53	6mm ² General purpose (GP) wire - Supply	m	100		
54	6mm ² General purpose (GP) wire - Install	m	100		

Carried to Collection

R

Section No. 3

Bill No. 2

ELECTRICAL CABLING and EXCAVATIONS

DEVELOPMENT BANK OF SOUTH AFRICA

Direct replacement of existing light switch (no wiring changes) and re-connecting the existing wiring

- 1 One-lever one-way switch as specified and re-connecting the existing wiring - Supply



No

1

- 2 One-lever one-way switch as specified and re-connecting the existing wiring - Install

No

1

Replacement of existing light switch including wiring. 2.5mm² Cu wiring, installed in existing conduit / trunking and connecting the wiring

- 3 One-lever one-way switch as specified - Supply



No

38

Carried to Collection

R

Section No. 3

Bill No. 3

ELECTRICAL LIGHT SWITCHES, SOCKETs, ISOLATOR

DEVELOPMENT BANK OF SOUTH AFRICA

- 4 One-lever one-way switch as specified - Install

No

38

Replacement of existing light switch including new wiring and new surface mounted conduit. 2.5mm² Cu wiring, 25mm Ø conduit complete with all fittings, elbows, draw boxes, switch box, installed in trunking and connecting the wiring



- 5 One-lever one-way switch, PVC Conduit, as specified and connecting the wiring - Supply

No

5

- 6 One-lever one-way switch, PVC Conduit, as specified and connecting the wiring - Install

No

5

SWITCHED SOCKET OUTLETS (SSO) and ISOLATORS (Isol)

Technical requirement Paragraph 3.2

Fitted in existing box complete with new steel cover

Carried to Collection

R

Section No. 3

Bill No. 3

ELECTRICAL LIGHT SWITCHES, SOCKETs, ISOLATOR

DEVELOPMENT BANK OF SOUTH AFRICA

Direct replacement of existing Switched Socket Outlet(s) (no wiring changes) and re-connecting the existing wiring

- 7 Single switched socket outlet (SSO) SANS 164-1 and re-connecting the existing wiring
In the documents this is referred to as a "Traditional 16A socket outlet" - Supply



No

1

- 8 Single switched socket outlet (SSO) SANS 164-1 and re-connecting the existing wiring
In the documents this is referred to as a "Traditional 16A socket outlet" - Install

No

1

Direct replacement of existing Isolator (no wiring changes) and re-connecting the existing wiring source and load side

- 9 30A 2-pole Isolator (Isol) as specified (100mm x 50mm) - Supply



No

2

Carried to Collection

R

Section No. 3

Bill No. 3

ELECTRICAL LIGHT SWITCHES, SOCKETS, ISOLATOR

DEVELOPMENT BANK OF SOUTH AFRICA

10 30A 2-pole Isolator (Isol) as specified (100mm x 50mm) - Install

No

2

Direct replacement of existing Switched Socket Outlet(s) including wiring. 4mm² Cu wiring, installed in existing conduit / trunking and re-connecting the existing wiring

11 Double switched socket outlet (DSSO) SANS 164-1 and re-connecting the existing wiring
In the documents this is referred to as a "Traditional 16A socket outlets" - Supply



No

18

12 Double switched socket outlet (DSSO) SANS 164-1 and re-connecting the existing wiring
In the documents this is referred to as a "Traditional 16A socket outlets" - Install

No

18

Carried to Collection

R

Section No. 3

Bill No. 3

ELECTRICAL LIGHT SWITCHES, SOCKETs, ISOLATOR

DEVELOPMENT BANK OF SOUTH AFRICA

- 13 Double switched socket outlet (DSSO) 1x SANS 164-1 and 1x SANS 164-2 (New SA outlet) and re-connecting the existing wiring

In the documents this is referred to as a "Traditional 16A socket outlet" and New SA outlet" - Supply



No

42

- 14 Double switched socket outlet (DSSO) 1x SANS 164-1 and 1x SANS 164-2 (New SA outlet) and re-connecting the existing wiring

In the documents this is referred to as a "Traditional 16A socket outlet" and New SA outlet" - Install

No

42

Carried to Collection

R

Section No. 3

Bill No. 3

ELECTRICAL LIGHT SWITCHES, SOCKETS, ISOLATOR

DEVELOPMENT BANK OF SOUTH AFRICA

Direct replacement of existing Isolator including wiring. 6mm² Cu wiring, installed in existing conduit / trunking and connecting and re-connecting the existing wiring source and load side

- 15 30A 2-pole Isolator (Isol) as specified (100mm x 50mm) and connecting the wiring - Supply



No

1

- 16 30A 2-pole Isolator (Isol) as specified (100mm x 50mm) and connecting the wiring - Install

No

1

Carried to Collection

R

Section No. 3

Bill No. 3

ELECTRICAL LIGHT SWITCHES, SOCKETs, ISOLATOR

DEVELOPMENT BANK OF SOUTH AFRICA

Replacement of existing Switched Socket Outlet(s) including wiring and surface mounted conduit. New 4mm² Cu wiring, new 25mm Ø conduit complete with all fittings, elbows, draw boxes, switch box, installed in trunking connecting wiring

- 17 Double switched socket outlet (DSSO) 1x SANS 164-1 and 1x SANS 164-2 (New SA outlet) and connecting the wiring.

In the documents this is referred to as a "Traditional 16A socket outlet" and New SA outlet" - Supply



No

5

- 18 Double switched socket outlet (DSSO) 1x SANS 164-1 and 1x SANS 164-2 (New SA outlet) and connecting the wiring.

In the documents this is referred to as a "Traditional 16A socket outlet" and New SA outlet" - Install

No

5

Carried to Collection

R

Section No. 3

Bill No. 3

ELECTRICAL LIGHT SWITCHES, SOCKETs, ISOLATOR

DEVELOPMENT BANK OF SOUTH AFRICA

Replacement of existing Isolator including wiring and surface mounted conduit. 4mm² Cu wiring, 25mm Ø conduit complete with all fittings, elbows, draw boxes, switch box, installed in trunking and connecting the wiring

- 19 30A 2-pole Isolator (Isol) as specified (100mm x 100mm) and connecting the wiring - Supply



No

4

- 20 30A 2-pole Isolator (Isol) as specified (100mm x 100mm) and connecting the wiring - Install

No

4

PHOTO (LIGHT) SENSITIVE DAY/NIGHT

Technical requirement Paragraph 3.2

NOTE: Photocell complete with NEMA base.

Base suitable to be wall mounted



- 21 Photo (light) sensitive Day/Night switch as specified, including 2.5mm² Cu wiring and connecting the wiring between DB and lights - Supply

No

1

Carried to Collection

R

Section No. 3

Bill No. 3

ELECTRICAL LIGHT SWITCHES, SOCKETs, ISOLATOR

DEVELOPMENT BANK OF SOUTH AFRICA

22	Photo (light) sensitive Day/Night switch as specified, including 2.5mm ² Cu wiring and connecting the wiring between DB and lights - Install	m	1		
23	Photo (light) sensitive Day/Night switch as specified, including wiring and surface mounted conduit. 2.5mm ² Cu wiring, 25mm Ø conduit complete with all fittings, elbows, draw boxes, switch box, installed in trunking and connecting the wiring between DB and lights - Supply	No	14		
24	Photo (light) sensitive Day/Night switch as specified, including wiring and surface mounted conduit. 2.5mm ² Cu wiring, 25mm Ø conduit complete with all fittings, elbows, draw boxes, switch box, installed in trunking and connecting the wiring between DB and lights - Install	No	14		
<p>POWER SKIRT <u>Technical requirement Paragraph 3.5</u> <u>2-cover-3-compartment power skirting complete with covers, and cover plates for socket outlets, RJ45, and RJ11 outlets. The bottom at 300mm above floor level, measured to the bottom of the power skirt, complete with conduit links. The technical specification details the outlets which must be included in the supply and installation</u></p>					
25	Power skirting - Supply	m	6		
26	Power skirting - Install	m	6		
Carried to Collection				R	
<p>Section No. 3 Bill No. 3 ELECTRICAL LIGHT SWITCHES, SOCKETS, ISOLATOR</p>					
DEVELOPMENT BANK OF SOUTH AFRICA					

Section No. 3

Bill No. 3

ELECTRICAL LIGHT SWITCHES, SOCKETs, ISOLATORS, etc

COLLECTION

Total Brought Forward from Page No.

**Page
No**

Amount

134

135

136

137

138

139

140

141

142

143

Carried Forward to Summary of Section No. 3

R

Section No. 3

Bill No. 3

ELECTRICAL LIGHT SWITCHES, SOCKETs, ISOLATOR

DEVELOPMENT BANK OF SOUTH AFRICA

Type F1 -White round surface mounted light fitting with cast aluminium base with round bulkhead light fitting, complete with LED 9W / $\pm 1\ 900$ Lumen, LED colour 4 000K (Neutral white 840), CRI (Ra) ≥ 80 , Luminaire efficacy shall exceed 105 lm / W, LED and Driver Lifespan 50 000 hours a matt polycarbonate diffuser. Complete with silicone gasket in groove, and lamps. Colour of the decorative trim ring shall be "White". The fitting shall have a power factor of at least 0.95. 230V 50Hz. Similar to the illustrations

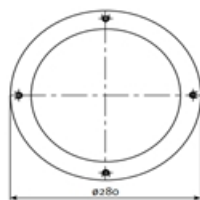

1	Supply, complete with lamps	No	81
2	Install and connect to existing wiring	No	3
3	Install, including 2.5mm ² Cu wiring in existing conduit etc. and connect.	No	56
4	Install, including wiring and surface mounted conduit. New 2.5mm ² Cu wiring, New 25mm Ø conduit complete with all fittings, elbows, draw boxes, switch box, installed in trunking and connecting the wiring	No	22

Carried to Collection

R

Section No. 3

Bill No. 4

ELECTRICAL LIGHT FITTINGS, LAMPS and FANS

DEVELOPMENT BANK OF SOUTH AFRICA

Type F2 - White round surface mounted light fitting with cast aluminium base with round bulkhead light fitting, complete with LED 9W / $\pm 1\ 900$ Lumen, LED colour 4 000K (Neutral white 840), CRI (Ra) ≥ 80 , Luminaire efficacy shall exceed 105 lm / W, LED and Driver Lifespan 50 000 hours a matt polycarbonate diffuser. Complete with silicone gasket in groove, and lamps. Colour of the base shall be "White". The fitting shall have a power factor of at least 0.95. 230V 50Hz. Similar to the illustrations

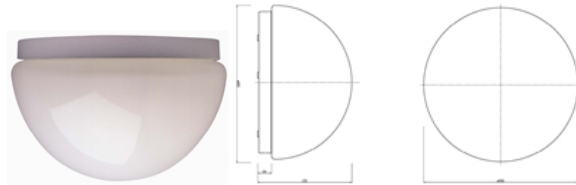

5	Supply, complete with lamps	No	10
6	Install, including 2.5mm ² Cu wiring in existing conduit etc. and connect.	No	9
7	Install, including wiring and surface mounted conduit. 2.5mm ² Cu wiring, 25mm Ø conduit complete with all fittings, elbows, draw boxes, switch box, installed in trunking and connecting the wiring	No	1

Carried to Collection

R

Section No. 3

Bill No. 4

ELECTRICAL LIGHT FITTINGS, LAMPS and FANS

DEVELOPMENT BANK OF SOUTH AFRICA

Type F2B - Indoor bulkhead light fitting complete with 1x 000 Lumen, $\pm 200^\circ$ Beam, LED colour 4 000K (Neutral white) efficacy shall exceed 105 lm / W, LED and Driver Lifespan

Similar to the illustrations



8 Supply, complete with lamps

No

3

9 Install, including wiring and surface mounted conduit. 2.5mm² Cu wiring, 25mm Ø conduit complete with all fittings, elbows, draw boxes, switch box, installed in trunking and connecting the wiring

No

3

Carried to Collection

R

Section No. 3

Bill No. 4

ELECTRICAL LIGHT FITTINGS, LAMPS and FANS

DEVELOPMENT BANK OF SOUTH AFRICA

Type F3 - Surface mounted 1,2 m – (1200mm 1x LED Open Channel fitting) complete with 1x LED “1200mm tube”, , each LED “Tube” shall comply with the following: colour 4 000K (Neutral white 840), CRI (Ra) ≥80, Luminaire efficacy shall exceed 105 lm / W, LED and Driver Lifespan 50 000 hours luminaire consisting of a ventilated, enclosed channel body. The body channel shall incorporate a removable cover acting as a reflector, less than 0,8 mm thick, designed and mounted to completely cover the interior of the body channel and its contents and extending over the full length of the luminaire up to the lamp holders. The electronic ballast approved. The fitting shall have a power factor of at least

Provide 20mm diameter entries at each end of the fitting shall be heat resistant with 105°C 600 V insulation. PF ≥0.

Similar to the illustration



10	Supply, complete with lamps	No	7
11	Install and connect to existing wiring	No	1
12	Install, including 2.5mm ² Cu wiring in existing conduit etc. and connect.	No	3
13	Install, including wiring and surface mounted conduit. 2.5mm ² Cu wiring, 25mm Ø conduit complete with all fittings, elbows, draw boxes, switch box, installed in trunking and connecting the wiring	No	3

Carried to Collection

R

Section No. 3

Bill No. 4

ELECTRICAL LIGHT FITTINGS, LAMPS and FANS

DEVELOPMENT BANK OF SOUTH AFRICA

Type F4 - Refer to Type F3 With 1,2 m – (1200mm 2x LED Open Channel fitting) complete with 2x LED “1200mm tubes”.

Similar to the illustration



14 Supply, complete with lamps

No

128

15 Install and connect to existing wiring

No

18

16 Install, including 2.5mm² Cu wiring in existing conduit etc. and connect.

No

110

Type F7 Safe in Use Warning / Pilot Light

The Contractor shall propose a suitable high efficiency LED luminaire, complete with 2-spare LED “lamps” which shall completion of the project as “Maintenance Spares”. The LED excess of 15 000hours. No fitting with separate control gear. Colour shall be RED.

Below is a image of an existing indication light, a bulhead red) is also a possibility

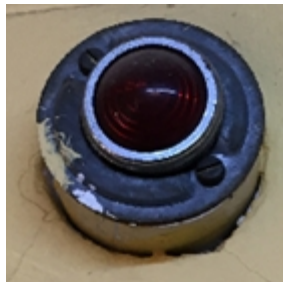

17 Supply, complete with lamps

No

1

Carried to Collection

R

Section No. 3

Bill No. 4

ELECTRICAL LIGHT FITTINGS, LAMPS and FANS

DEVELOPMENT BANK OF SOUTH AFRICA

18	Install, including wiring and surface mounted conduit. 2.5mm ² Cu wiring, 25mm Ø conduit complete with all fittings, elbows, draw boxes, switch box, installed in trunking and connecting the wiring	No	1		
	<u>Type F9 - Moisture proof light fitting</u>				
	<u>Surface mounted weatherproof 1,2 m – (1200mm 2x LED tube”, each LED “Tube” shall comply with the following: 15 colour 4 000K (Neutral white 840), CRI (Ra) ≥80, Luminair LED and Driver Lifespan 50 000 hours . The internal wiring V insulation. Provide 20mm diameter entries at each end internal wiring shall be heat resistant with 105°C 600 V ins the illustration at bottom of this page</u>				
19	Supply, complete with lamps	No	15		
20	Install and connect to existing wiring	No	6		
21	Install, including 2.5mm ² Cu wiring in existing conduit etc. and connect.	No	8		
22	Install, including wiring and surface mounted conduit. 2.5mm ² Cu wiring, 25mm Ø conduit complete with all fittings, elbows, draw boxes, switch box, installed in trunking and connecting the wiring	No	1		
Carried to Collection				R	
Section No. 3					
Bill No. 4					
ELECTRICAL LIGHT FITTINGS, LAMPS and FANS					
DEVELOPMENT BANK OF SOUTH AFRICA					

CEILING FANS

Technical requirement Paragraph 3.6

Wall mounted, industrial fan. Rotor diameter ±600mm. Metal and metal blades. Complete with 5step speed controller, suitable for 230V, 50Hz with an approximate power consumption of 200W.



23	Supply	No	2
24	Install and connect to existing wiring	No	2
25	Install, including 2.5mm ² Cu wiring in existing conduit etc. and connect.	No	2
26	Install, including wiring and surface mounted conduit. 2.5mm ² Cu wiring, 25mm Ø conduit complete with all fittings, elbows, draw boxes, switch box, installed in trunking and connecting the wiring	No	2

Carried to Collection

R

Section No. 3

Bill No. 4

ELECTRICAL LIGHT FITTINGS, LAMPS and FANS

DEVELOPMENT BANK OF SOUTH AFRICA

Section No. 3

Bill No. 4

ELECTRICAL LIGHT FITTINGS, LAMPS and FANS

COLLECTION

Total Brought Forward from Page No.

**Page
No**

Amount

145

146

147

148

149

150

151

152

Carried Forward to Summary of Section No. 3

R

Section No. 3

Bill No. 4

ELECTRICAL LIGHT FITTINGS, LAMPS and FANS

DEVELOPMENT BANK OF SOUTH AFRICA

Block 1

· Replace Utility DB

- o Supplied from DB Utility
- o Supply: Cable 3x 6mm² 1c Cu PVC GP (L+N+PE)

· Required equipment

- o 1x 20A, 10kA, 2-pole CB "Mains"
- o 1x 63A, L+N ELU 3kA "ELU"
- o 1x Class II Surge protection, 275V, 10kA (8/20µs) L+N with indication
- o 1x 15A, 5kA, 1-pole CB "Plugs"
- o 1x 10A, 5kA, 1-pole CB "Lights"
- o 1x 10A, 5kA, 1-pole CB "Outside Lights"
- o Escutcheon fillers
- o Door / Cover

· Identify and Label Circuits

· Labelling

- o DB Name
- o Supply from
- o Supply cable size
- o Fault level
- o Outgoing Circuits

· New printed/typed legend

· CoC

1 Supply

No

1

2 Install

No

1

Carried to Collection

R

Section No. 3

Bill No. 5

ELECTRICAL DISTRIBUTION BOARDS and COC's

DEVELOPMENT BANK OF SOUTH AFRICA

Block 1

· Replace Utility DB

- o Outdoor, wall mounted, with padlock able doors, weatherproof, vandal proof lock covers, mounted in full sun, colour "Grey"
- o Supplied from Utility
- o Cable entry and exit: Bottom
- o Feeder Cables:

§ Supply: 35mm² 4c Cu PVC/SWA/PVC + 25mm² black insulated EW (L1/2/3+N+PE)

§ Feeder 1 (Block 10): 35mm² 4c Cu PVC/SWA/PVC+ 25mm² black insulated EW (L1/2/3+N+PE)

§ Feeder 2 (Block 1: Guard House): 3x 6mm² 1c Cu PVC GP (L+N+PE)

· Required equipment

- o 1x 80A, 15kA, 3-pole CB "Mains"
- o 1x Class II Surge protection, 275V, 10kA (8/20µs) L1/L2/L3/N with indication
- o 80A, 10kA, 3-pole CB "Supply to DB Block 10"
- o 30A, 10kA, 2-pole CB "Supply to DB Block 1: Guard House". Feed from L1
- o Escutcheon fillers
- o Door / Cover

· Identify and Label Circuits

· Labelling

- o DB Name
- o Supply from
- o Supply cable size
- o Fault level
- o Outgoing Circuits

· New printed/typed legend

· CoC

3 Supply

No

1

4 Install

No

1

Carried to Collection

R

Section No. 3

Bill No. 5

ELECTRICAL DISTRIBUTION BOARDS and COC's

DEVELOPMENT BANK OF SOUTH AFRICA

DB Block 3

- Rewire DB
- Required equipment
 - o 1x 30A, 10kA, 2-pole CB "Mains"
 - o 1x 63A, L+N ELU 3kA "ELU"
 - o 1x Class II Surge protection, 275V, 10kA (8/20µs)
 - o L+N with indication
 - o 2x 20A, 5kA, 1-pole CB "Plugs"
 - o 1x 10A, 5kA, 1-pole CB "Lights"
 - o 1x 10A, 5kA, 1-pole CB "Outside Lights"
 - o 1x 10A, 5kA, 1-pole CB
 - o Escutcheon fillers
 - o Door / Cover
- Identify and Label Circuits
- Labelling
 - o DB Name
 - o Supply from
 - o Supply cable size
 - o Fault level
 - o Outgoing Circuits
- New printed/typed legend
- CoC

5	Supply	No	1
6	Install	No	1

Carried to Collection

R

Section No. 3
Bill No. 5

ELECTRICAL DISTRIBUTION BOARDS and COC's

DEVELOPMENT BANK OF SOUTH AFRICA

DB: Block 4

- None. Use Isolator as Local Main Switch
- Identify and Label Circuits
- Labelling
 - o DB Name
 - o Supply from
 - o Circuit on Supply DB
- CoC

DB: Block 5

- None. Use Isolator as Local Main Switch
- Identify and Label Circuits
- Labelling
 - o DB Name
 - o Supply from
 - o Circuit on Supply DB
- CoC

DB: Block 6

- None. Use Isolator as Local Main Switch
- Identify and Label Circuits
- Labelling
 - o DB Name
 - o Supply from
 - o Circuit on Supply DB
- CoC

7	Supply	No	3
8	Install	No	3

Carried to Collection

R

Section No. 3

Bill No. 5

ELECTRICAL DISTRIBUTION BOARDS and COC's

DEVELOPMENT BANK OF SOUTH AFRICA

DB: Block 7

- None. Use Isolator as Local Main Switch
- Identify and Label Circuits
- Labelling
 - o DB Name
 - o Supply from
 - o Circuit on Supply DB
- CoC

DB: Block 8

- Repair DB
- Required equipment
 - o Escutcheon covers ("blanks")
- Identify and Label Circuits
- Labelling
 - o DB Name
 - o Supply from
 - o Supply cable size
 - o Fault level
 - o Outgoing Circuits
- New printed/typed legend
- CoC

9	Supply	No	2
10	Install	No	2

Carried to Collection

Section No. 3
Bill No. 5

ELECTRICAL DISTRIBUTION BOARDS and COC's

DEVELOPMENT BANK OF SOUTH AFRICA

R

DB: Block 9 & 10

· Replace DB 1

· Required equipment

- o 1x 60A, 5kA, 2-pole CB "Mains"
- o 1x 50A, 5kA, 2-pole CB
- o 1x 63A, L+N ELU 3kA "ELU"
- o 1x Class II Surge protection, 275V, 10kA (8/20µs)
- o L+N with indication
- o 2x 20A, 5kA, 1-pole CB "Plugs"
- o 2x 10A, 5kA, 1-pole CB "Lights"
- o 1x 10A, 5kA, 1-pole CB "Outside Lights"
- o Escutcheon fillers
- o Door / Cover

· Identify and Label Circuits

· Labelling

- o DB Name
- o Supply from
- o Supply cable size
- o Fault level
- o Outgoing Circuits

· New printed/typed legend

· CoC

11 Supply

No

1

12 Install

No

1

Carried to Collection

R

Section No. 3

Bill No. 5

ELECTRICAL DISTRIBUTION BOARDS and COC's

DEVELOPMENT BANK OF SOUTH AFRICA

DB: Block 9 & 10

· Replace DB 2

· Required equipment

o 1x 50A, 5kA, 2-pole CB "Mains"

o 1x 63A, L+N ELU 3kA "ELU"

o 1x Class II Surge protection, 275V, 10kA (8/20µs)
L+N with indication

o 2x 20A, 5kA, 1-pole CB "Plugs"

o 2x 10A, 5kA, 1-pole CB "Lights"

o 1x 10A, 5kA, 1-pole CB "Outside Lights"

o Escutcheon fillers

o Door / Cover

· Identify and Label Circuits

· Labelling

o DB Name

o Supply from

o Supply cable size

o Fault level

o Outgoing Circuits

· New printed/typed legend

· CoC

13 Supply

No

1

14 Install

No

1

Carried to Collection

R

Section No. 3

Bill No. 5

ELECTRICAL DISTRIBUTION BOARDS and COC's

DEVELOPMENT BANK OF SOUTH AFRICA

DB: Block 11

- Replace DB 1
- Required equipment
 - o 1x 60A, 5kA, 2-pole CB "Mains"
 - o 1x 63A, L+N ELU 3kA "ELU"
 - o 1x Class II Surge protection, 275V, 10kA (8/20μs)
 - o L+N with indication
 - o 2x 20A, 5kA, 1-pole CB "Plugs"
 - o 2x 10A, 5kA, 1-pole CB "Lights"
 - o 1x 10A, 5kA, 1-pole CB "Outside Lights"
 - o Escutcheon fillers
 - o Door / Cover
- Identify and Label Circuits
- Labelling
 - o DB Name
 - o Supply from
 - o Supply cable size
 - o Fault level
 - o Outgoing Circuits
- New printed/typed legend
- CoC

15	Supply	No	1
16	Install	No	1

DB: Block 12

- Replace DB
- Required equipment
 - o 1x 60A, 5kA, 2-pole CB "Mains"
 - o 1x 63A, L+N ELU 3kA "ELU"
 - o 1x Class II Surge protection, 275V, 10kA (8/20μs)
 - o L+N with indication
 - o 2x 20A, 5kA, 1-pole CB "Plugs"
 - o 2x 10A, 5kA, 1-pole CB "Lights"
 - o 1x 10A, 5kA, 1-pole CB "Outside Lights"
 - o Escutcheon fillers

Carried to Collection

R

Section No. 3

Bill No. 5

ELECTRICAL DISTRIBUTION BOARDS and COC's

DEVELOPMENT BANK OF SOUTH AFRICA

- o Door / Cover
- Identify and Label Circuits
- Labelling
 - o DB Name
 - o Supply from
 - o Supply cable size
 - o Fault level
 - o Outgoing Circuits
- New printed/typed legend
- Repair DB (School numbering – Outside Room 50)
 - o Clean DB
 - Required equipment
 - o 1x 60A, 5kA, 3-pole CB “Mains”
 - o 3x 63A, L+N ELU 3kA “ELU”
 - o 1x 50A, 5kA, 2-pole CB
 - o 1x Class II Surge protection, 275V, 10kA (8/20μs)
 - o L1, 2, 3 +N with indication
 - o 6x 25A, 5kA, 1-pole CB
 - o 9x 15A, 5kA, 1-pole CB
 - o Door / Cover
- Identify and Label Circuits
- Labelling
 - o DB Name
 - o Supply from
 - o Supply cable size
 - o Fault level
 - o Outgoing Circuits
- New printed/typed legend
- CoC

17	Supply	No	1
18	Install	No	1

Carried to Collection

R

Section No. 3
Bill No. 5

ELECTRICAL DISTRIBUTION BOARDS and COC's

DEVELOPMENT BANK OF SOUTH AFRICA

DB: Block 13

· Replace DB

· Required equipment

- o 1x 60A, 5kA, 2-pole CB "Mains"
- o 1x 63A, L+N ELU 3kA "ELU"
- o 1x Class II Surge protection, 275V, 10kA (8/20μs)
- o L+N with indication
- o 2x 20A, 5kA, 1-pole CB "Plugs"
- o 2x 10A, 5kA, 1-pole CB "Lights"
- o 1x 10A, 5kA, 1-pole CB "Outside Lights"
- o Escutcheon fillers
- o Door / Cover

· Identify and Label Circuits

· Labelling

- o DB Name
- o Supply from
- o Supply cable size
- o Fault level
- o Outgoing Circuits

· New printed/typed legend

· CoC

19	Supply	No	1
20	Install	No	1

Carried to Collection

R

Section No. 3

Bill No. 5

ELECTRICAL DISTRIBUTION BOARDS and COC's

DEVELOPMENT BANK OF SOUTH AFRICA

DB: Block 14

· Replace DB

· Required equipment

- o 1x 60A, 5kA, 2-pole CB "Mains"
- o 1x 63A, L+N ELU 3kA "ELU"
- o 1x Class II Surge protection, 275V, 10kA (8/20µs)
- o L+N with indication
- o 2x 20A, 5kA, 1-pole CB "Plugs"
- o 2x 10A, 5kA, 1-pole CB "Lights"
- o 1x 10A, 5kA, 1-pole CB "Outside Lights"
- o Escutcheon fillers
- o Door / Cover

· Identify and Label Circuits

· Labelling

- o DB Name
- o Supply from
- o Supply cable size
- o Fault level
- o Outgoing Circuits

· New printed/typed legend

· CoC

21	Supply	No	1
22	Install	No	1

Carried to Collection

R

Section No. 3

Bill No. 5

ELECTRICAL DISTRIBUTION BOARDS and COC's

DEVELOPMENT BANK OF SOUTH AFRICA

DB: Block 15

· Replace DB

· Required equipment

- o 1x 30A, 5kA, 2-pole CB "Mains"
- o 1x 63A, L+N ELU 3kA "ELU"
- o 1x Class II Surge protection, 275V, 10kA (8/20μs)
- o L+N with indication
- o 1x 20A, 5kA, 1-pole CB "Plugs"
- o 1x 10A, 5kA, 1-pole CB "Lights"
- o 1x 10A, 5kA, 1-pole CB "Outside Lights"
- o Escutcheon fillers
- o Door / Cover
- o

· Identify and Label Circuits

· Labelling

- o DB Name
- o Supply from
- o Supply cable size
- o Fault level
- o Outgoing Circuits

· New printed/typed legend

· CoC

23	Supply	No	1
24	Install	No	1

Carried to Collection

R

Section No. 3

Bill No. 5

ELECTRICAL DISTRIBUTION BOARDS and COC's

DEVELOPMENT BANK OF SOUTH AFRICA

DB: Block 16 & 17

· Replace DB

· Required equipment

- o 1x 30A, 5kA, 2-pole CB "Mains"
- o 1x 63A, L+N ELU 3kA "ELU"
- o 1x Class II Surge protection, 275V, 10kA (8/20μs)
- o L+N with indication
- o 1x 20A, 5kA, 1-pole CB "Plugs"
- o 1x 10A, 5kA, 1-pole CB "Lights"
- o 1x 10A, 5kA, 1-pole CB "Outside Lights"
- o Escutcheon fillers
- o Door / Cover

· Identify and Label Circuits

· Labelling

- o DB Name
- o Supply from
- o Supply cable size
- o Fault level
- o Outgoing Circuits

· New printed/typed legend

· CoC

25	Supply	No	1
26	Install	No	1

Carried to Collection

Section No. 3

Bill No. 5

ELECTRICAL DISTRIBUTION BOARDS and COC's

DEVELOPMENT BANK OF SOUTH AFRICA

R

DB: Block 18

· None. Use Isolator as Local Main Switch

· Identify and Label Circuits

· Labelling

o DB Name

o Supply from

o Circuit on Supply DB

· CoC

27 Supply

No

1

28 Install

No

1

Carried to Collection

R

Section No. 3

Bill No. 5

ELECTRICAL DISTRIBUTION BOARDS and COC's

DEVELOPMENT BANK OF SOUTH AFRICA

Section No. 3
Bill No. 5
ELECTRICAL DISTRIBUTION BOARDS and COC's

-169-

Bill No	SECTION SUMMARY - ELECTRICAL WORK	Page No	Amount
1	ELECTRICAL PRELIMINARY and GENERAL	126	
2	ELECTRICAL CABLING and EXCAVATIONS	133	
3	ELECTRICAL LIGHT SWITCHES, SOCKETS, ISOLATORS, etc	144	
4	ELECTRICAL LIGHT FITTINGS, LAMPS and FANS	153	
5	ELECTRICAL DISTRIBUTION BOARDS and COC's	169	
Section No. 3		Carried to Final Summary	
DEVELOPMENT BANK OF SOUTH AFRICA		R	

8.3.3 Overhaul

8.3.4 Importing of materials from commercial Sources

7	Topsoil	m3	100
---	---------	----	-----

8.3.8.1 Location

9	8.3.9 Extra-over for backfill or for fill material against struc	m3	20
---	--	----	----

R

EARTHWORKS (PIPE TRENCHES) (SANS 1200 DE

8.3.1 Site clearance and (if specified) removal of topsoil

10	Clear vegetation and trees of girth up to 1 m	m	348
11	Remove topsoil to depth of 150mm	m ²	348

8.3.2 Excavation

Excavate in all materials for trenches, backfill, compact and dispose of surplus material

12	Up to 125 mm dia pipes for depths Over and up to 0 m 1,0 m	m	303
13	Over 125 mm and up to 700 mm dia pipes for depths Over and up to 0,0 m 1,0 m	m	45
	<u>Extra-over item (a) above for:</u>		
14	Intermediate excavation	m ³	70

8.3.3 Excavation ancillaries

Carried to Collection

Section No. 4
Bill No. 1
EXTERNAL WORK

DEVELOPMENT BANK OF SOUTH AFRICA

R

	<u>8.3.3.1 Make up deficiency in backfill material (provisional</u>				
15	By importation from commercial sources	m3	52		
	<u>8.3.6 Finishing</u>				
	<u>8.3.6.1 Reinstate surfaces complete with all courses</u>				
16	Asphalt of thickness 50mm in parking area	m2	77		
17	Concrete of thickness 150mm in corridors	m2	50		
	<u>GABIONS AND PITCHING (SANS 1200 DK)</u>				
	<u>8.2.1 Surface preparation for bedding of gabions</u>				
18	Cavities filled with approved excavated material or rock	m2	150		
	<u>8.2.3 Gabions and mattresses</u>				
	<u>PVC-coated galvanized wire gabion boxes</u>				
19	1 m x 1 m x 0.5 m box, wire dia. 2.7 mm, mesh size 80 x 100 mm	m3	3		
20	1 m x 1 m x 1 m box, wire dia. 2.7 mm, mesh size 80 x 100 mm	m3	6		
	Carried to Collection			R	
	Section No. 4				
	Bill No. 1				
	EXTERNAL WORK				
	DEVELOPMENT BANK OF SOUTH AFRICA				

21	2 m x 1 m x 0.5 m box, wire dia. 2.7 mm, mesh size 80 x 100 mm	m3	48		
22	2 m x 1 m x 1 m box, wire dia. 2.7 mm, mesh size 80 x 100 mm	m3	72		
	<u>PVC-coated galvanized wire gabion mattresses 300mm thi</u>				
23	4 m x 3 m, 80 x 100 mm mesh size, 2.7 mm dia wire, and 1000 mm diaphragm spacing	m3	72		
24	4 m x 4 m, 80 x 100 mm mesh size, 2.7 mm dia wire, and 1000 mm diaphragm spacing	m3	96		
	<u>8.2.4 Geotextile (or geomembrane)</u>				
25	Bidim A4	m2	180		
	<u>CONCRETE (STRUCTURAL)</u> <u>(SANS1200 G)</u>				
	<u>8.2 SCHEDULED FORMWORK ITEMS</u>				
	<u>8.2.1 Rough (Class F1 finish)</u> <u>Vertical</u>				
26	Walkway slabs	m2	45		
	Carried to Collection			R	
Section No. 4 Bill No. 1 EXTERNAL WORK					
DEVELOPMENT BANK OF SOUTH AFRICA					

8.3 SCHEDULED REINFORCEMENT ITEMS

-176-

8.2.1 Supply, lay and bed pipes on Class B bedding complete with couplings with 500mm cover

uPVC Class 12

34 110mm diameter

m

20

HDPE PN10

35 450mm diameter

m

30

36 600mm diameter

m

15

8.2.2 Extra-over 8.2.1 for the supplying, laying, and bedding specials complete with couplings

90° Bend

Equal tees

37 50 x 2" Male adaptors

No

2

8.2.3 Extra-over 8.2.1 for the supplying, fixing, and bedding valves

38 50 mm (RSV) socketed gate valve

m

2

Carried to Collection

R

Section No. 4
Bill No. 1
EXTERNAL WORK

DEVELOPMENT BANK OF SOUTH AFRICA

	<u>8.2.13 Anchor/thrust blocks and pedestals</u>				
39	Concrete, class 25/20	m3	4		
40	Formwork, wooden planks	m2	158		
	<u>Extra-over 8.2.1 for the supplying, fixing, and bedding of Hydrant</u>				
41	90 mm Fire Hydrant Assembly	No	2		
	<u>PS 8.2.16 Potable and Fire water storage as per drawing L0826-00-D-01A05-00</u>				
42	5250 l JoJo water storage tank or similar	No	2		
43	Installation of pipes and valves complete as per drawing	No	1		
	<u>BEDDING (PIPES) (SANS 1200 LB)</u>				
	<u>8.2.1 Provision of bedding from trench excavation</u>				
44	Selected granular fill	m3	49		
	<u>8.2.2 Supply only of bedding by importation</u>				
	<u>8.2.2.3 From commercial sources</u>				
45	Selected granular material	m3	74		
	Carried to Collection			R	
	Section No. 4				
	Bill No. 1				
	EXTERNAL WORK				
	DEVELOPMENT BANK OF SOUTH AFRICA				

<u>SEWERS (SANS 1200 LD)</u>					
46	8.2.13 Cleaning of existing Sewer system	m	100		
<u>STORMWATER DRAINAGE (SANS 1200 LE)</u>					
<u>8.2 Interlocking joint, Class 75 on Class B bedding</u>					
<u>8.2.3 Extra-Over Items 8.2.1 and 8.2.2 for Supplying End Units for Culverts with a Skew of more than 20 degrees</u>					
47	600mm DIA pipe culvert	No	1		
<u>8.2.8 Supply and Install Manholes, Catchpits, and the Like</u>					
48	1200 mm DIA concrete manhole, 2m deep	No	1		
<u>8.2.10 Accessories</u>					
49	Manhole covers including frames, Type 4	No	4		
50	500mm x 500mm Fibre glass grid (depth is 25mm with 50mm x 50mm pitch)	No	4		
51	Drainage grate 500 x 1000 mm	No	8		
Carried to Collection				R	
Section No. 4 Bill No. 1 EXTERNAL WORK					
DEVELOPMENT BANK OF SOUTH AFRICA					

ERF CONNECTIONS (WATER) (SANS 1200 LF)

52	8.2.1 Provide Erf Connections Complete as per drawing L0826-00-D-01A11-00. Connection to exiting water supply to be liaised with local authority.	No	1
----	---	----	---

SEGMENTED PAVING (SANS 1200 MJ)

8.2 Provide and Construct paving complete on 25mm riversand bedding

53	8.2.1 Provision of Edge Restraints	m	75
54	8.2.2 80mm Grey Interlocking	m ²	170
55	8.2.3 Cutting Units to Fit Edge Restraints	m	75

KERBING AND CHANNELLING (SANS 1200 MK)

8.2.1 Precast concrete kerbing (Supply and install)

Fig 5a Barrier kerb

56	Straight kerbing	m	50
----	------------------	---	----

Fig 13 Edge Beam

57	Straight kerbing	m	50
----	------------------	---	----

Carried to Collection

Section No. 4
Bill No. 1
EXTERNAL WORK

DEVELOPMENT BANK OF SOUTH AFRICA

R

ANCILLARY ROADWORKS (SANS 1200 MM)

FENCING

TRADE NAMES

Whenever a trade name for any product has been described in the Priced Document, the tenderer's attention is drawn to the fact that any other product of equal quality may be used subject to written approval of the Representative Agent being obtained prior to the closing date of submission of tenders. If prior written approval for an alternative product is not obtained, the product described shall be deemed to have been tendered for.

58	Take down and remove existing boundary wire fence to a dump site to be located by the contractor	m	624
59	Vehicle access gate 6m x 2,5 meter high, construct with 50x50x5mm square tubing on sliding rail.	No	2

Carried to Collection

R

Section No. 4

Bill No. 1

EXTERNAL WORK

DEVELOPMENT BANK OF SOUTH AFRICA

R

"Polycop" polypropylene pipes

Polypropylene pipes 54mm diameter and under shall be seamless copper coloured class 16 pipes jointed with "Fast-fuse" heat welded thermoplastic or brass compression fittings as designed for use with copper pipes as stated

Pipes shall be firmly fixed to walls etc with coloured nylon snap-in pipe clips with provision for accommodating thermal movement and jointed and fixed strictly in accordance with the manufacturer's instructions

All pipe diameters are nominal external

"Polylink" polypropylene pipes

Polypropylene pipes 63mm diameter and over shall be class 12 pipes jointed with cast iron "Supraclamp" running joints

Fusion welded bends, once or twice mitred as necessary, and tees shall be factory manufactured

Fusion welded bends and tees shall include jointing to pipes with PVC rubber ring double Z joint couplers

Branch tees shall include flanged and bolted joints to "Polycop" branch pipes in addition and for brass compression male iron to copper straight couplers

Reducers shall include jointing to pipes with PVC rubber ring double Z joint couplers and reducers shall be of sufficient overall length to accommodate same

All pipes shall be jointed and fixed strictly in accordance with the manufacturer's instructions

All pipe diameters are nominal external

Carried to Collection

Section No. 4

Bill No. 2

WATER RETICULATION

DEVELOPMENT BANK OF SOUTH AFRICA

R

Polypropylene pipes

Polypropylene pipes 54mm diameter and under shall be seamless copper coloured class 16 pipes jointed with fast-fuse heat welded thermoplastic or brass compression fittings as designed for use with copper pipes as stated

Pipes shall be firmly fixed to walls etc with coloured nylon snap-in pipe clips with provision for accommodating thermal movement and jointed and fixed strictly in accordance with the manufacturer's instructions

Polypropylene pipes 63mm diameter and over shall be class 12 pipes jointed with cast iron "Supraclamp" running joints

Fusion welded bends, once or twice mitred as necessary, and tees shall be factory manufactured

Fusion welded bends and tees shall include jointing to pipes with PVC rubber ring double Z joint couplers

Branch tees shall include flanged and bolted joints to branch pipes in addition and for brass compression male iron to copper straight couplers

Reducers shall include jointing to pipes with PVC rubber ring double Z joint couplers and reducers shall be of sufficient overall length to accommodate same

All pipes shall be jointed and fixed strictly in accordance with the manufacturer's instructions

All pipe diameters are nominal external

uPVC pipes and fittings

Soil, waste and vent pipes and fittings shall be solvent weld jointed

Carried to Collection

Section No. 4

Bill No. 2

WATER RETICULATION

DEVELOPMENT BANK OF SOUTH AFRICA

R

uPVC pressure pipes and fittings

Pipes for water supply shall be of the class stated

Pipes of 40mm diameter and smaller shall be plain ended with solvent welded uPVC loose sockets and fittings

Pipes of 50mm diameter and greater shall have sockets and spigots with push in type integral rubber ring joints. Bends shall be uPVC and all other fittings shall be cast iron, all with similar push-in type joints

Reducing fittings

Where fittings have reducing ends or branches they are described as "reducing". In the case of pipes with diameters not exceeding 60mm only the largest end or branch size is given. Should the contractor wish to use other fittings and bushes or reducers he may do so on the understanding that no claim in this regard will be entertained. In the case of pipes with diameters exceeding 60mm all sizes are given and no claim for extra bushes, reducers, etc will be entertained

Exposed concrete surfaces

Exposed surfaces of concrete stormwater channels, cover slabs, inspection eye marker slabs, gulley tops, cleaning eye tops, catchpits, inspection chambers, etc shall be finished smooth with plaster

Excavations

No claim for rock excavation will be entertained unless the contractor has timeously notified the quantity surveyor thereof prior to backfilling

"Soft rock" and "hard rock" shall be as defined in "Earthworks"

Carried to Collection

Section No. 4

Bill No. 2

WATER RETICULATION

DEVELOPMENT BANK OF SOUTH AFRICA

R

Laying, backfilling, bedding, etc. of pipes

Pipes shall be laid and bedded and trenches shall be carefully backfilled in accordance with manufacturers' instructions

Where no manufacturers' instructions exist pipes shall be laid in accordance with SANS 2001-DP1

Holes for pipes

Holes for pipes, cutting and fitting around pipes, the making good thereof, etc. in brick and/or concrete sidewalls of catch pits, manholes, valve chambers, etc. shall be deemed to be included in descriptions of pipework

Tendered rates must make provision for this as no additional claims in this regard will afterwards be entertained

WATER RETICULATION

Supply, Lay and bed uPVC pipe complete: (The rate shall exclude disinfection of pipes after completion of hydraulic pipe test)

1	75mm Dia uPVC pipe class 12	m	283
	<u>Fittings and specials - uPVC bends(Extra-over rate to items 3.1.1 to 3.1.6)</u>		
2	75mm 22.5 degree bend	No	2
3	75mm 45 degree bend	No	6
4	75mm 90 degree bend	No	12
	<u>Special fittings - uPVC Tees:(Extra-over rate to items 3.1.1 to 3.1.6)</u>		
5	75mm dia. Equal Tees	No	4
6	110mm x 75mm unequal tees	No	9

Carried to Collection

R

Section No. 4

Bill No. 2

WATER RETICULATION

DEVELOPMENT BANK OF SOUTH AFRICA

7	<u>Valve Chamber:</u> Valve chamber - 1200 x 1400 x 1000mm deep, complete including excavations, materials, plant, labor, incidentals, etc. as per detail drawings.	No	1	
8	<u>TESTING</u> Testing water pipe system		Item	
	<p style="text-align: right;">Carried to Collection</p> <p>Section No. 4 Bill No. 2 WATER RETICULATION</p> <p style="text-align: right;">DEVELOPMENT BANK OF SOUTH AFRICA</p>		R	

Section No. 4

Bill No. 2

WATER RETICULATION

COLLECTION

Total Brought Forward from Page No.

**Page
No**

Amount

183

184

185

186

187

188

Carried Forward to Summary of Section No. 4

R

Section No. 4

Bill No. 2

WATER RETICULATION

DEVELOPMENT BANK OF SOUTH AFRICA

Bill No	SECTION SUMMARY - EXTERNAL WORK	Page No	Amount
1	EXTERNAL WORK	182	
2	WATER RETICULATION	189	
Section No. 4		Carried to Final Summary	
DEVELOPMENT BANK OF SOUTH AFRICA		R	

Attendance

It will be expected from the Contractor to render all general attendance and, if specifically so described, special attendance services to each relevant Specialist, all in accordance with the Clauses set out in the "Preliminaries" section

The item "Attendance" which follows each of the provisional sums for nominated and/or selected sub-contractors' work, shall be deemed to cover all the contractor's costs incurred in providing free of charge to the Nominated and/or Selected Sub-contractors, the following:

1. The services as set out in the clauses in the "Preliminaries" section
2. Making good in all trades and cleaning down and removal of rubbish on completion

The Contractor may allow next to "Attendance" items for the recovery of such costs he might consider necessary

Also refer to the Clauses in the "Preliminaries" section for the definitions and adjustment of "Attendance" and "Special Attendance" respectively

PROVISIONAL SUMS FOR SELECTED SUBCONTRACT WORKS

These scheduled allowances are for work to be executed under separate selected and/or nominated sub-contracts by firms of Specialists to be nominated by the Employer

All provisional sums cover the supply and installation of material, equipment, plant, etc., including the commissioning thereof, where applicable

BUDGETARY ALLOWANCE

Carried to Collection

R

Section No. 5

Bill No. 1

PROVISIONAL SUMS

DEVELOPMENT BANK OF SOUTH AFRICA

**Kwazulu Natal Department of Education
Asbestos Replacement
Bhekokuhle Primary School**

<u>COMMUNITY LIAISON OFFICER</u>			
1	Provide the amount of R100 000.00 (One hundred Thousand Rands) nett for Community Liason Officer's Salary to be omitted in part or whole as instructed by Principal Agent (R10 000 per month)	Item	100,000.00
<u>KITCHEN and TUCK SHOP</u>			
2	Allow the amount R150 000.00 (One hundred and fifty Thousand Rands) for upgrading the existing Kitchen and tuck shop container to comply with OHS act regulations	Item	150,000.00
<u>APPROVED INSPECTION AUTHORITY (AIA) INSPECTIONS</u>			
3	Allow the amount R175 000.00 (One hundred Seventy Five Thousand Rands) for AIA inspections, reports, etc on Asbestos removal	Item	175,000.00
<u>BOUNDARY FENCING</u>			
4	Allow the amount of R1 498 000.00 (One million Four Hundred ninety eight thousand Rands) for the supply and installation of a new fence.	Item	1,498,000.00
5	Profit and attendance on the above	Item	
MINIMUM TARGETED ENTERPRISE DEVELOPMENT			
A provisional amount has been allowed for in the execution of this project as described in C3.1 Project Specifications. The provisional amount allowed is for the appointment of training coordinator, mentor, training service providers and training of the beneficiary enterprises including monitoring and monthly reporting.		PS	R143 497.26
Allowance for profit all inclusive of associated costs to the contractor for implementation.		%	
Allowance for attendance all inclusive of associated costs to the contractor for implementation.		%	
Carried to Collection			
Section No. 5 Bill No. 1 PROVISIONAL SUMS			
DEVELOPMENT BANK OF SOUTH AFRICA			

Section No. 5

Bill No. 1

PROVISIONAL SUMS

COLLECTION

Total Brought Forward from Page No.

**Page
No**

Amount

191

192

193

Carried to Final Summary

R

Section No. 5

Bill No. 1

PROVISIONAL SUMS

DEVELOPMENT BANK OF SOUTH AFRICA

FINAL SUMMARY					
Section No		Page No		Amount	
1	PRELIMINARIES	50			
2	BUILDINGS	121			
3	ELECTRICAL WORK	170			
4	EXTERNAL WORK	190			
5	PROVISIONAL SUMS	194			
	TOTAL (EXCLUDING VAT)		R		
	Allow 5% Contingency Amount for the unforeseen and the sum provided is under the sole control of the client and upon approval by the Client Representative and deducted in whole or in part.		R		
	TOTAL (INCLUDING CONTINGENCY)		R		
	VAT @ 15%		R		